

Overview

What's New

- New Compaq ProLiant™ DL580 900 MHz Model offers improved performance and increased availability including:
 - Two Intel® Pentium® III Xeon™ 900 MHz Processors with 2-MB L2 Cache
 - Two Hot Plug, Redundant Power Supplies standard (450-Watt)
 - 1024 MB PC100 ECC SDRAM Memory standard (with Advanced ECC functionality)

At A Glance

- Rack optimized (4U = 7") 4-way computing power for your data center or ISP/ASP environments
- Intel Pentium III Xeon 900 MHz or 700 MHz Processors (up to 4) with 1-MB (700 MHz only), or 2-MB L2 Cache (900 MHz)
- ServerWorks Enterprise ServerSet III HE chipset
- 1024 MB (900 MHz Models) or 512 MB (700 MHz Models) PC100 ECC SDRAM Memory with Advanced ECC functionality, expandable to 16 GB
- Six PCI slots, 4 Hot Pluggable:
 - Two 64-bit/66-MHz Hot Plug
 - Two 64-bit/33-MHz Hot Plug
 - One 64-bit/33-MHz Non-Hot Plug
 - One 32-bit/33-MHz Non-Hot Plug
- Integrated Compaq NC3134 Fast Ethernet NIC 64 PCI Dual Base 10/100 in a slot (upgradable to Gigabit)
- Integrated Smart Array Controller (Two channel - embedded on the peripheral board)
- Internal Hot Plug Drive Storage of up to 587.2 GB with 146.8-GB 1" Ultra320 hard drives
- Industry-Standard PCI Hot Plug with push button functionality
- 7 x 24 cooling provided by 8 Hot Plug Redundant System Fans
- 450W Hot Plug Redundant Power Supplies (2 std on 900 MHz, 1 std on 700 MHz with optional RPS)
- Toolless internal design for easy access to system components, improved Serviceability and Intelligent Manageability
- Protected by HP Services, including a three-year, Next Business Day on-site, limited, Global warranty and extended Pre-Failure Warranty that covers processors, memory and disk drives — Certain restrictions and exclusions apply. Consult the Customer Support Center at 1-800-345-1518 for details.

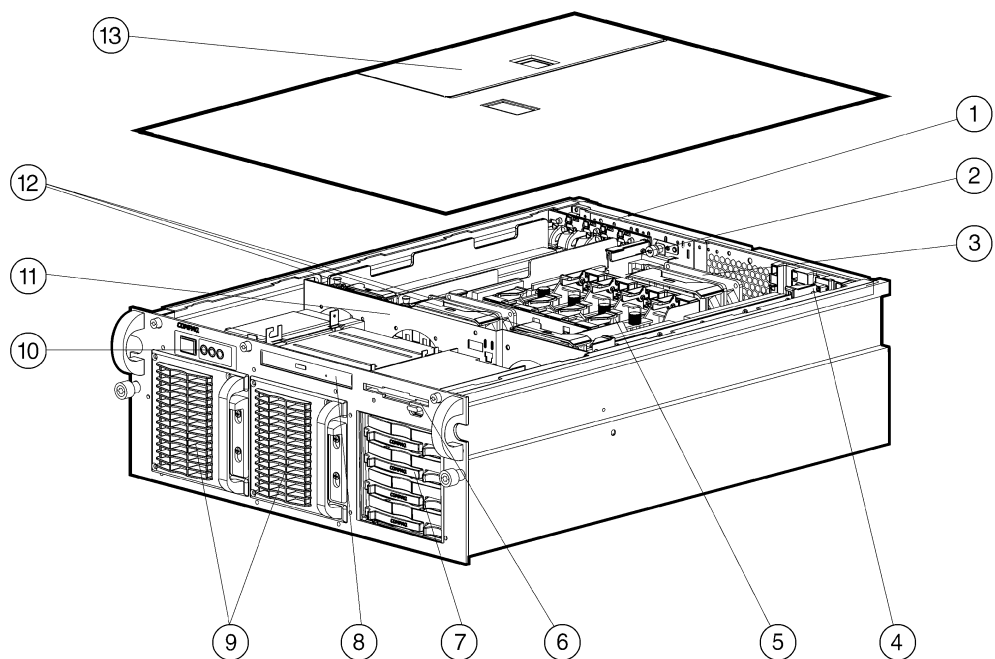

1. Six PCI I/O Slots (Five 64-bit slots, two 66-MHz slots, four hot plug)
2. Peripheral Board with Integrated Smart Array Controller
3. Redundant Hot Plug Fan
4. Memory Board with 16 DIMM sockets
5. Processors (up to 4 supported)
6. 1.44-MB Diskette Drive
7. 4 x 1" Wide Ultra2/Ultra3-ready Drive Cage standard
8. Low-profile 24x IDE CD-ROM
9. Hot Plug Redundant Power Supplies (2 shown) (700 MHz Models ship standard with one - optional RPS available)
10. Front Panel LED Display
11. Removable Center Wall
12. Additional Hot Plug Redundant Fans
13. Hot Plug PCI Access Door

Standard Features

Processor <i>One of the following depending on Model</i>	Intel Pentium III Xeon processor 900 MHz NOTE: One or two processors ship standard depending on model. Intel Pentium III Xeon processor 700 MHz NOTE: One or two processors ship standard depending on model.	
Cache Memory <i>One of the following depending on Model</i>	2-MB level 2 writeback cache per processor standard NOTE: 900 MHz and 700 MHz Models. 1-MB level 2 writeback cache per processor standard NOTE: 700 MHz Models only.	
Upgradability	Upgradable to quad processing	
Chipset	ServerWorks Enterprise ServerSet III HE chipset NOTE: For more information regarding ServerWorks, please see the following URL: http://www.serverworks.com/products/overview.html .	
Memory <i>One of the following depending on Model</i>	Standard	1024 MB (PC100-MHz ECC SDRAM Memory with Advanced ECC functionality) (900 MHz Models)
	Maximum	16 GB
	Standard	512 MB (PC100-MHz ECC SDRAM Memory with Advanced ECC functionality) (700 MHz Models)
	Maximum	16 GB
	NOTE: Advanced ECC Memory Technology protects the data even in the event of an entire SDRAM component failure. Embedded in the chipset design, this feature allows the use of Industry-Standard Registered DIMMs.	
Network Controller	Integrated Compaq NC3134 Fast Ethernet NIC 64 PCI Dual Base 10/100 in a slot (upgradable to Gigabit)	
Expansion Slots	I/O (6 Total, 5 Available)	PCI Voltage:
	64-bit/66-MHz PCI Hot Plug	2, 1 available 3.3 Volt Only
	64-bit/33-MHz PCI Hot Plug	2, 2 available 5 Volt or 3.3 Volt
	64-bit/33-MHz PCI Non-Hot Plug	1, 1 available 5 Volt or 3.3 Volt
	32-bit/33-MHz PCI Non-Hot Plug	1, 1 available 5 Volt Only
Storage Controller	Integrated Smart Array Controller (Two channel) (supports Internal RAID 0, 1, 0+1, 5 and external tape devices) NOTE: The Integrated Smart Array Controller is embedded on the peripheral board.	
Storage	Diskette Drives	1.44 MB
	CD-ROM	24x IDE CD-ROM Drive (slim line)
	Hard Drives	None
	Maximum Internal Storage	587.2 GB (4 x 146.8 GB Ultra320 1" drives) (internal hot plug Ultra2/Ultra3-ready drive cage)
Interfaces	Parallel	1
	Serial	1 (NOTE: You can configure a second serial device to your ProLiant DL580 server by installing the auxiliary serial connector that ships with the server. The auxiliary connector attaches to a serial port B on the peripheral board and exits the rear of the server through the auxiliary serial knockout located directly above the dual power feeds.)
	Pointing Device (Mouse)	1
	Graphics	1
	Hot Plug Keyboard	1
	External Wide Ultra2 SCSI	1
	Network RJ-45	2

Standard Features

Graphics	Integrated 1280 x 1024, 16M color on PCI local bus, 4-MB video memory
Form Factor	Rack (4U = 7 inches), ships with sliding rails and cable management arm
ProLiant Essentials Foundation Pack Software	<p>Insight Manager 7 helps maximize system uptime and performance and reduces the cost of maintaining the IT infrastructure by providing proactive notification of problems before those problems result in costly downtime and reduced productivity. Insight Manager 7 is easy to set up and provides rapid access to detailed fault and performance information gathered by the Management Agents. One-click access to the Integrated Lights-Out or Remote Insight Lights Out Edition board allows systems administrators to take full graphical control of ProLiant servers in remote locations or lights-out data centers. Finally, Insight Manager 7 in concert with the Version Control Agents and Version Control Repository Manager enables systems administrators to version manage and update system software across groups of ProLiant servers.</p>
	<p><i>SmartStart</i>[™] SmartStart is a tool that simplifies server setup, providing a rapid way to deploy reliable and consistent server configurations. For more information, please visit the SmartStart website at http://www.hp.com/servers/smartstart. Minimum SmartStart version supported: 4.70 (700 MHz Models) Minimum SmartStart version supported: 5.00 (900 MHz Models)</p>
	<p>Management Agents The Management Agents form the foundation for HP's Intelligent Manageability strategy. They provide direct, browser-based access to in-depth instrumentation built into HP servers, workstations, desktops, and portables, and send alerts to Insight Manager 7 and other enterprise management applications in case of subsystem or environmental failures. For additional information about the Management Agents and other management products from HP, please visit the management website at http://www.hp.com/servers/manage.</p>
	<p><i>ActiveUpdate</i>[™] ActiveUpdate is a web-based application that keeps IT managers directly connected to HP for proactive notification and delivery of the latest software updates.</p>
	<p>ROMPac[™], support software, and configuration utilities The latest software, drivers, and firmware fully optimized and tested for your ProLiant server and options.</p>
	<p><i>Survey Utility</i>[™] and diagnostics utilities The most advanced configuration analysis, reporting and troubleshooting utilities used by HP and at your fingertips.</p>
	<p><i>Optional</i> ProLiant Essentials Value Packs Optional software offerings that selectively extend the functionality of an Adaptive Infrastructure to address specific business problems and needs:</p> <ul style="list-style-type: none"> • Rapid Deployment Pack – an automated solution for multi-server deployment and provisioning, enabling companies to quickly and easily adapt to changing business demands. • Workload Management Pack – provides easier management of complex environments, improving overall server utilization and enabling Windows[®] 2000 customers for the first time to confidently deploy multiple applications on a single multiprocessor ProLiant Server. • Recovery Server Option Pack – entry-level high availability software that will provide reliable protection and increased uptime against server hardware and operating system failures. • Performance Management Pack – a performance management solution that identifies and explains hardware performance bottlenecks on ProLiant servers and attached options enabling users to better utilize their valuable resources.
	<p>NOTE: Flexible and volume quantity license kits are available for ProLiant Essentials Value Packs. Refer to http://www.hp.com/servers/ProLiantessentials or the various ProLiant Essentials Value Pack product QuickSpecs for more information.</p>
	<p>NOTE: For more information regarding ProLiant Essentials Software, please see the following URL: http://www.hp.com/servers/proliantessentials.</p>
	<p>NOTE: These Web sites are available in English only.</p>

Standard Features

Industry Standard Compliance

ACPI 2.0 Compliant
PCI 2.2 Compliant
PXE Support (Optional when configured with a PXE-enabled slot-based NIC)
WOL Support
Physical Address Extension (PAE) Support
Microsoft® Logo certifications

Intelligent Manageability

Remote Insight Lights-Out Edition support
Automatic Server Recovery-2 (ASR-2)
Insight Manager 7
Integrated Remote Console (IRC) (with an internal modem)
Integrated Management Log (IML)
Hot Spare Boot (**NOTE:** Upon the event of a failed processor or VRM in a multi-processing environment, the system will automatically reboot and use the remaining good processor(s).)
Dynamic sector repairing and drive parameter tracking (with Smart Array controllers)
Redundant/adaptive load balancing NIC Support

Availability

PCI Hot Plug with push button functionality
7 x 24 cooling provided by 8 Hot Plug Redundant System Fans
Integrated Smart Array Controller for RAID data protection/performance and maximum data bandwidth
Advanced Error Checking and Correcting (ECC) Technology
NOTE: Advanced ECC Memory Technology protects the data even in the event of an entire SDRAM component failure. Embedded in the chipset design, this feature allows the use of Industry-Standard Registered DIMMs.
Hot Plug Ultra2/Ultra3 Drive Bays
Redundant Hot Plug Power Supplies (standard on 900 MHz Models; available on 700 MHz Models with optional RPS)
Redundant NIC support
Pre-Failure Warranty (covers processors, hard drives, and memory)

Serviceability

Internal Diagnostics Display (IDD) numerically indicates specific DIMM or processor failure.
LED display on front panel indicates power/interlock, fan, and memory/microprocessor health
Spring-loaded memory board release latches prevent unseating incidents
PCI Card Guide locks full length PCI cards in place during transit
Customer driven interior system fan design (all system fans interior to chassis)
Removable, internal center panel eases access to the power supply and hard drive backplane boards
Optional High Voltage PDU cable exits chassis at a right angle to simplify cable management at rear of chassis

Security

Power-on password
Hot plug keyboard password
Diskette drive control
Diskette boot control
Network Server Mode
Parallel and serial interface control
Administrator's password
Disk configuration lock

Standard Features

Power Supply	450-Watt Hot Plug Power Supply NOTE: One 450-Watt Hot Plug Power Supply ships standard with 700 MHz Models (optional Redundant Hot Plug Power Supply Option Kit). NOTE: Two 450-Watt Hot Plug Power Supplies ship standard with 900 MHz Models.
System Fans	8 Hot Plug Redundant System Fans ship standard (8 internal fans maximum supported).
Required Cabling	For required cabling information, refer to the Compaq Web site at http://www.compaq.com/products/servers/ProLiantDL580/ .
OS Support	Microsoft Windows NT [®] Server Microsoft Windows 2000 Novell [®] NetWare [®] SCO [®] OpenServer [®] SCO UnixWare [®] IBM OS/2 Warp Family LINUX [®] (Red Hat [®] , SuSE [®] , TurboLinux Server, Caldera [®] eServer) Sun [™] Solaris [™] Intel Platform Edition NOTE: For a more complete and up-to-date listing of supported OSs and versions, please visit our OS Support Matrix at: ftp://ftp.compaq.com/pub/products/servers/os-support-matrix-310.pdf . NOTE: For an up-to-date listing of the latest drivers available for the Compaq ProLiant DL580, please see: http://www.compaq.com/support/files/server/us/index.html .
Rack Airflow Requirements	<ul style="list-style-type: none">• Rack 9000 and 10000 series Cabinets The increasing power of new high-performance processor technology requires increased cooling efficiency for rack-mounted servers. The Compaq 9000 Series Rack and the new 10000 Series Racks provides enhanced airflow for maximum cooling, allowing these racks to be fully loaded with servers using the latest processors.• Rack 7000 series Cabinets When installing a server with processors running at speeds of 550 MHz or greater in Compaq Rack 7000 series racks with glass doors (165753-001 (42U), and 163747-001 (22U)), the new processor technology requires the installation of Compaq's new High Airflow Rack Door Inserts (327281-B21 (42U), 327281-B22 (42U 6 pack), or 157847-B21 (22U)) to promote enhanced airflow for maximum cooling. <p>CAUTION: If a third-party rack is used, observe the following additional requirements to ensure adequate airflow and to prevent damage to the equipment:</p> <ul style="list-style-type: none">○ Front and rear doors: If your 42U server rack includes closing front and rear doors, you must allow 830 square inches (5,350 sq cm) of hole evenly distributed from top to bottom to permit adequate airflow (equivalent to the required 64 percent open area for ventilation).○ Side: The clearance between the installed rack component and the side panels of the rack must be a minimum of 2.75 inches (7 cm). <p>CAUTION: Always use blanking panels to fill all remaining empty front panel U-spaces in the rack. This arrangement ensures proper airflow. Using a rack without blanking panels results in improper cooling that can lead to thermal damage.</p> <p>NOTE: For additional information, refer to the Setup and Installation Guide or the Documentation CD provided with the server, or to the server documentation located in the Support section at the following URL: http://www5.compaq.com/products/servers/ProLiantdl580/index2.html.</p>

Standard Features

Service and Support

HP Services provides a three-year, limited warranty, including Pre-Failure Warranty (coverage of hard drives, memory and processors) fully supported by a worldwide network of resellers and service providers. HP technical assistance is available 7x24, toll free in the United States and Canada. Telephone support services may be covered under warranty or available for an additional fee.

NOTE: Limited Warranty includes 3 year Parts, 3 year Labor, 3-year on-site support.

A full range of *CarePac*™ packaged hardware and software services:

- Installation and start up
- Extended coverage hours and enhanced response times
- System management and performance services
- Availability and recovery services

NOTE: For more information, customer/resellers can contact <http://www.compaq.com/services>.

Please see the following URL regarding Warranty Information For Your HP Products:
http://www.compaq.com/support/warranty_upgrades/web_statements/176738.html.

For additional information regarding Worldwide Limited Warranty and Technical Support, please see the following URL: <ftp://ftp.compaq.com/pub/supportinformation/ejourney/176738.pdf>.

NOTE: Certain restrictions and exclusions apply. Consult the Customer Support Center at 1-800-345-1518 for details.

Models

DL580R01 X900-2MB, 1024MB (2P) <i>155618-xx3</i>	Processor	(2) Intel Pentium III Xeon 900 MHz Processors standard (up to 4 supported)
	Cache Memory	2-MB Level 2 writeback cache per processor
	Memory	1024 MB (Standard) to 16 GB (Maximum)
	Network Controller	Integrated Compaq NC3134 Fast Ethernet NIC 64 PCI Dual Port 10/100 in a slot
	Storage Controller	Integrated Smart Array Controller (Two channel)
	Hard Drive	None ship standard
	Internal Storage	587.2 GB maximum (with optional hard drives)
	Power Supply	Two 450W Power Supplies
	Optical Drive	24x IDE CD-ROM Drive
Form Factor	Rack 4U	
DL580R01 X700-2MB, 512MB (2P) <i>155618-xx1</i>	Processor	(2) Intel Pentium III Xeon 700 MHz Processors standard (up to 4 supported)
	Cache Memory	2-MB Level 2 writeback cache per processor
	Memory	512 MB (Standard) to 16 GB (Maximum)
	Network Controller	Integrated Compaq NC3134 Fast Ethernet NIC 64 PCI Dual Port 10/100 in a slot
	Storage Controller	Integrated Smart Array Controller (Two channel)
	Hard Drive	None ship standard
	Internal Storage	587.2 GB maximum (with optional hard drives)
	Power Supply	One 450W Power Supply
	Optical Drive	24x IDE CD-ROM Drive
Form Factor	Rack 4U	
DL580R01 X700-1MB, 512MB (1P) <i>155617-xx1</i>	Processor	(1) Intel Pentium III Xeon 700 MHz Processor standard (up to 4 supported)
	Cache Memory	1-MB Level 2 writeback cache per processor
	Memory	512 MB (Standard) to 16 GB (Maximum)
	Network Controller	Integrated Compaq NC3134 Fast Ethernet NIC 64 PCI Dual Port 10/100 in a slot
	Storage Controller	Integrated Smart Array Controller (Two channel)
	Hard Drive	None ship standard
	Internal Storage	587.2 GB maximum (with optional hard drives)
	Power Supply	One 450W Power Supply
	Optical Drive	24x IDE CD-ROM Drive
Form Factor	Rack 4U	
Country Code Key	XX=00	U.S.
	XX=01	Australia
	XX=42	Int'l, Europe, Germany, France
	XX=03	UK
	XX=37	APD
	XX=29	Japan
	XX=AA	PRC

Options

ProLiant DL580 Unique Options	Compaq Hot Plug Redundant Power Supply Option Kit (U.S.)	105739-001	
	Compaq Hot Plug Redundant Power Supply Option Kit (Australia)	105739-011	
	Compaq Hot Plug Redundant Power Supply Option Kit (Int'l)	105739-021	
	Compaq Hot Plug Redundant Power Supply Option Kit (Japan)	105739-291	
Software	HP digital asset protection	302316-001	
ProLiant Essentials Value Pack Software	Rapid Deployment Pack, 1 User, V1.x NOTE: This license allows 1 server to be managed and deployed via the Deployment Server.	267196-B21	
	Rapid Deployment Pack, 1 User, V1.x (Japan) NOTE: This license allows 1 server to be managed and deployed via the Deployment Server.	267196-291	
	Rapid Deployment Pack, 10 Users, V1.x NOTE: This license allows 10 servers to be managed and deployed via the Deployment Server.	269817-B21	
	Rapid Deployment Pack, 10 Users, V1.x (Japan) NOTE: This license allows 10 servers to be managed and deployed via the Deployment Server.	269817-291	
	ProLiant Essentials Workload Management Pack (Featuring Resource Partitioning Manager version 2.0)	303284-B21	
	ProLiant Essentials Performance Management Pack v2.0, Single License	306696-B21	
	ProLiant Essentials Recovery Server Option Pack NOTE: Flexible and volume quantity license kits are available for ProLiant Essentials Value Packs. Refer to http://www.hp.com/servers/proliantessentials or the various ProLiant Essentials Value Pack product QuickSpecs for more information. NOTE: For more information regarding ProLiant Essentials Software, please see the following URL: http://www.hp.com/servers/proliantessentials . NOTE: These Web sites are available in English only.	280189-B21	
	Software – Secured Solutions	InterScan/Immunix Secured Solution for HP ProLiant servers	307039-B21
	NetServer to ProLiant integrations services	HP NetServer to ProLiant integration and assessment service NOTE: HP identifies current levels of NetServer support, services, and management. This service helps maximize customer's ability to add ProLiant platforms into their current environment.	304164-002
		HP TopTools to Insight Manager 7 installation and startup service NOTE: Provides on-site review, installation and configuration services for Insight Manager 7. HP will also re-create, as closely as possible, the views and reports from the customer's current TopTools configuration. This service assures a smooth transition to the ProLiant Essentials software.	304163-002
HP NetServer to ProLiant Essentials Rapid Deployment Pack installation and startup service NOTE: Install and configure Rapid Deployment Pack in a test environment, then deploy a server image to a maximum of 250 systems in the production environment. This service helps to assure successful system deployment.		304162-002	
Processor	Pentium III Xeon X900-2MB Processor Option Kit NOTE: This processor option kit (PN 222627-B21) supports the ProLiant DL580 and the ProLiant ML570 servers.	222627-B21	
	Pentium III Xeon X700-2MB Processor Option Kit NOTE: This processor option kit (PN 174449-B21) supports the ProLiant DL580 and the ProLiant ML570 servers.	174449-B21	
	Pentium III Xeon X700-1MB Processor Option Kit NOTE: This processor option kit (PN 174448-B21) supports the ProLiant DL580 and the ProLiant ML570 servers.	174448-B21	

Options

Memory (DIMMs)	4096-MB PC100 Registered ECC SDRAM Memory Kit (4 x 1024 MB)	189083-B21
	2048-MB PC100 Registered ECC SDRAM Memory Kit (4 x 512 MB)	189082-B21
	1024-MB PC100 Registered ECC SDRAM Memory Kit (4 x 256 MB)	189081-B21
	512-MB PC100 Registered ECC SDRAM Memory Kit (4 x 128 MB)	189080-B21
Hard Drives	Ultra320 SCSI – Universal Hot Plug	
	36.4GB 10,000 rpm, U320 Universal Hard Drive, 1"	286713-B22
	72.8GB 10,000 rpm, U320 Universal Hard Drive, 1"	286714-B22
	146.8GB 10,000 rpm, U320 Universal Hard Drive, 1"	286716-B22
	18.2GB 15,000 rpm, U320 Universal Hard Drive, 1"	286775-B22
	36.4GB 15,000 rpm, U320 Universal Hard Drive, 1"	286776-B22
	72.8GB 15,000 rpm, U320 Universal Hard Drive, 1"	286778-B22
	NOTE: All U320 Universal Hard Drives are backward compatible to U2 or U3 speeds. U320 drives require an optional U320 Smart Array Controller or U320 SCSI HBA to support U320 transfer rates.	
	NOTE: Please see the Hard Drive QuickSpecs for Technical Specifications such as capacity, height, width, interface, transfer rate, seek time, physical configuration, and operating temperature: U320 Hard Drive OS: http://www5.compaq.com/products/quickspecs/11531_div/11531_div.HTML (Division/World Wide) http://www5.compaq.com/products/quickspecs/11531_na/11531_na.HTML (North America)	
	Storage Controllers	Smart Array 532 Controller
Smart Array 532 Controller (Japan)		225338-291
Smart Array 5302/128 Controller		283552-B21
Smart Array 5302/128 Controller (Japan)		283552-291
Smart Array 5304/256 Controller		283551-B21
Smart Array 5304/256 Controller (Japan)		283551-291
Smart Array 5312 Controller		238633-B21
Smart Array 5312 Controller (Japan)		238633-291
Ultra3 Channel Expansion Module for Smart Array 5300 Controller		153507-B21
128-MB Cache Module for Smart Array 5302 Controller		153506-B21
RAID ADG Upgrade for Smart Array 5302		288601-B21
256-MB Battery-Backed Cache Module		254786-B21
NOTE: This 256-MB Battery-Backed Cache Module supports the Smart Array 5300 series controllers, MSA 1000 and the Smart Array Cluster Storage.		
64-bit/66-MHz Single Channel Wide Ultra3 SCSI Adapter		154457-B21
64-bit/66-MHz Dual Channel Wide Ultra3 SCSI Adapter		129803-B21
64-Bit/133-MHz Dual Channel Ultra320 SCSI Adapter		268351-B22
64-Bit/66-MHz Dual Channel Wide Ultra3 SCSI Adapter, Alternate OS		284688-B21
NOTE: Please see the following Controller or SCSI Adapter QuickSpecs for Technical Specifications such as PCI Bus, PCI Peak Data Transfer Rate, SCSI Protocols supported, SCSI Peak Data Transfer Rate, Channels, SCSI Ports, Drives supported, Cache, RAID support, and additional information: http://www5.compaq.com/products/quickspecs/10851_div/10851_div.HTML (Smart Array 532) http://www5.compaq.com/products/quickspecs/10640_div/10640_div.HTML (Smart Array 5300 Series) http://www5.compaq.com/products/quickspecs/11328_div/11328_div.HTML (Smart Array 5312) http://www5.compaq.com/products/quickspecs/10429_div/10429_div.HTML (SCSI Adapter) http://www5.compaq.com/products/quickspecs/11555_div/11555_div.HTML (U320 Adapter)		

Options

Communications	Compaq NC3123 Fast Ethernet NIC PCI 10/100 WOL	174830-B21
	Compaq NC3134 Fast Ethernet NIC 64 PCI Dual Port 10/100	138603-B21
	Compaq NC3135 Fast Ethernet Module Dual 10/100 Upgrade Module for NC3134 and NC3131	138604-B21
	Compaq NC6132 Gigabit Module 1000 SX Upgrade Module for NC3134 and NC3131	338456-B23
	Compaq NC6133 Gigabit Module 1000 LX Upgrade Module for NC3134 and NC3131	338456-B24
	Compaq NC3133 Fast Ethernet Module 100 FX Upgrade Module for NC3134 and NC3131	338456-B25
	Compaq NC6136 Gigabit Server Adapter, 64-bit/66-MHz, PCI, 1000 SX	203539-B21
	Compaq NC7131 Gigabit Server Adapter, 64 bit/66-MHz PCI, 10/100/1000-T	158575-B21
	Compaq NC7132 10/100/1000-T Upgrade Module for NC3134 and NC3131	153543-B21
Redundant Options	Compaq Hot Plug Redundant Power Supply Option Kit (U.S.)	105739-001
	Compaq Hot Plug Redundant Power Supply Option Kit (Australia)	105739-011
	Compaq Hot Plug Redundant Power Supply Option Kit (Int'l)	105739-021
	Compaq Hot Plug Redundant Power Supply Option Kit (Japan)	105739-291
Management Options	Remote Insight Lights-Out Edition II (NA, LA)	227251-001
	Remote Insight Lights-Out Edition II (EMEA)	227251-021
	Remote Insight Lights-Out Edition II (ROW)	227251-371
	Compaq Remote Insight Lights-Out Edition (NA, LA)	157866-001
	Compaq Remote Insight Lights-Out Edition (EMEA)	157866-021
	Compaq Remote Insight Lights-Out Edition (ROW)	157866-371
Security	HP/Atalla AXL600L SSL Accelerator Card for ProLiant Servers	524545-B21
	Compaq AXL300 Accelerator PCI Card for ProLiant Servers	227933-B21
Monitors	Essential Series	
	Compaq S9500 CRT Monitor (19-inch, Carbon/Silver)	261615-XXX
	Compaq S7500 CRT Monitor (17-inch, Carbon/Silver)	261606-XXX
	Compaq S5500 CRT Monitor (15-inch Carbon/Silver)	261602-XXX
	Compaq TFT1501 Flat Panel Monitor (15-inch, Carbon/Silver, North America)	301042-003
	Compaq TFT1501 Flat Panel Monitor (15-inch, Carbon/Silver, Outside North America)	P4825D-XXX
	Compaq TFT1701 Flat Panel Monitor (17-inch, Carbon/Silver, North America)	292847-003
	Compaq TFT1701 Flat Panel Monitor (17-inch, Carbon/Silver, Outside North America)	P9019A-XXX
	Advantage Series	
	Compaq V7550 CRT Color Monitor (17-inch, Carbon/Silver)	261611-XXX
	Compaq TFT1720 Flat Panel Monitor (17-inch, Carbon/Silver, North America)	295926-003
	Compaq TFT1720 Flat Panel Monitor (17-inch, Carbon/Silver, outside North America)	D5064D-XXX
	Compaq FT1720M Flat Panel Monitor (17-inch, (Carbon/Silver, includes speaker, USB port, headphone, North America)	301958-003
	Compaq TFT1720M Flat Panel Monitor (17-inch, (Carbon/Silver, includes speaker, USB port, headphone, outside North America)	D5064P-XXX
	Compaq TFT1520 Flat Panel Monitor (15-inch, Carbon/Silver, North America)	295925-003
	Compaq TFT1520 Flat Panel Monitor (15-inch, Carbon/Silver, outside North America)	D5063D-XXX
	Compaq TFT1520M Flat Panel Monitor (15-inch, (Carbon/Silver includes speaker, USB port, headphone, North America)	301957-003
	Compaq TFT1520M Flat Panel Monitor (15-inch, (Carbon/Silver includes speaker, USB port, headphone, outside North America)	D5063P-XXX

Options

Monitors (continued)

Performance Series

HP P930 CRT Monitor (19-inch, Flat-screen, Carbon/Silver, North America)	302268-003
HP P930 CRT Monitor (19-inch, Flat-screen, Carbon/Silver, Outside North America)	P909W-XXX
HP P1130 CRT Monitor (21-inch, Flat-screen, Carbon/Silver, North America)	302270-003
HP P1130 CRT Monitor (21-inch, Flat-screen, Carbon/Silver, Outside North America)	P4819-XXX
HP L1825 Flat Panel Monitor (18-inch, Carbon/Silver, North America)	303486-003
HP L1825 Flat Panel Monitor (18-inch, Carbon/Silver, Outside North America)	P9021W-XXX
HP L2025 Flat Panel Monitor (20-inch, Carbon/Silver, North America)	303102-003
HP L2025 Flat Panel Monitor (20-inch, Carbon/Silver, Outside North America)	P4831W-XXX
Compaq TFT1825 Flat Panel Monitor (18-inch, Carbon/Silver, North America)	296751-003
Compaq TFT1825 Flat Panel Monitor (18-inch, Carbon/Silver, Outside North America)	P9021A-XXX
Compaq TFT2025 Flat Panel Monitor (20-inch, Carbon/Silver, North America)	285550-003
Compaq TFT2025 Flat Panel Monitor (20-inch, Carbon/Silver, Outside North America)	P4831D-XXX

Rackmount Flat Panel Monitors

TFT5110R Flat Panel Monitor (Carbon)	281683-B21
TFT5010R Flat Panel Monitor (NA)	217248-001
TFT5010R Flat Panel Monitor (Int'l)	217248-B31
TFT5010R Flat Panel Monitor (Japan)	217248-291

Tape Drives

External DAT Tape Drives

HP StorageWorks 20/40-GB DAT DDS-4 Tape Drive, External (Carbon) (NA)	157770-002
HP StorageWorks 20/40-GB DAT DDS-4 Tape Drive, External (Int'l) (Carbon)	157770-B32
HP StorageWorks 20/40-GB DAT DDS-4 Tape Drive, External (Japan) (Carbon)	157770-292
HP StorageWorks Internal 20/40-GB DAT, Hot Plug (Carbon)	215488-B21

NOTE: Please see the 20/40-GB DAT Tape Drive QuickSpecs for additional options such as host bus adapters, controllers, cassettes, and for an up-to-date listing of the latest O/S Support details, please see the following:

http://www5.compaq.com/products/quickspecs/10426_div/10426_div.HTML (Division/World Wide)
http://www5.compaq.com/products/quickspecs/10426_na/10426_na.HTML (North America)

External AIT Tape Drives

HP StorageWorks External AIT 35-GB, LVD Tape Drive (Carbon)	216885-001
HP StorageWorks External AIT 35-GB, LVD Tape Drive (Carbon) (Int'l)	216885-B31
HP StorageWorks External AIT 35-GB, LVD Tape Drive (Carbon) (Japan)	216885-291
HP StorageWorks Internal AIT 35-GB, LVD, Hot Plug (Carbon)	216886-B21

NOTE: Please see the AIT 35 GB, LVD Tape Drive QuickSpecs for additional options such as adapters, controllers, and cassettes, and for an up-to-date listing of the latest O/S Support details, please see the following:

http://www5.compaq.com/products/quickspecs/10712_div/10712_div.HTML (Division/World Wide)
http://www5.compaq.com/products/quickspecs/10712_na/10712_na.HTML (North America)

HP StorageWorks AIT 50-GB Tape Drive, External (Carbon) (NA)	157767-002
HP StorageWorks AIT 50-GB Tape Drive, External (Int'l) (Carbon)	157767-B32
HP StorageWorks AIT 50-GB Tape Drive, External (Japan) (Carbon)	157767-292
HP StorageWorks Internal AIT 50-GB, Hot Plug (Carbon)	215487-B21
HP StorageWorks AIT 50GB Tape Drive, 3U Rackmount	274333-B21

NOTE: Please see the AIT 50-GB Tape Drive QuickSpecs for additional options such as adapters, controllers, and cassettes, and for an up-to-date listing of the latest O/S Support details, please see the following:

http://www5.compaq.com/products/quickspecs/10425_div/10425_div.HTML (Division/World Wide)
http://www5.compaq.com/products/quickspecs/10425_na/10425_na.HTML (North America)

HP StorageWorks External AIT 100-GB Tape Drive (Carbon)	249160-001
HP StorageWorks External AIT 100-GB Tape Drive (Carbon) (Int'l)	249160-B31
HP StorageWorks Internal AIT 100-GB, Hot Plug (Carbon)	249161-B21

NOTE: Please see the AIT 100-GB Tape Drive QuickSpecs for additional options such as adapters, controllers, and cassettes, and for an up-to-date listing of the latest O/S Support details, please see the following:

http://www5.compaq.com/products/quickspecs/11062_div/11062_div.HTML (Division/World Wide)
http://www5.compaq.com/products/quickspecs/11062_na/11062_na.HTML (North America)

Options

Tape Drives *(continued)*

External DLT/SDLT Tape Drives

HP StorageWorks 40/80-GB DLT Tape Drive, External (Carbon) (NA)	146197-B22
HP StorageWorks 40/80-GB DLT Tape Drive, External (Carbon) (Japan)	146197-293
HP StorageWorks Rackmount DLT 40/80, 3U (Single Drive)	274332-B21
HP StorageWorks Rackmount DLT 40/80, Dual Drive 3U (Two Drives)	274335-B21
HP StorageWorks Rackmount DLT 40/80, Tape Array III, 5U (Four Drives)	274337-B21

NOTE: Please see the 40/80-GB DLT Drive QuickSpecs for additional options such as host bus adapters, controllers, cassettes, and for an up-to-date listing of the latest O/S Support details, please see the following:

http://www5.compaq.com/products/quickspecs/10658_div/10658_div.HTML (Division/World Wide)
http://www5.compaq.com/products/quickspecs/10658_na/10658_na.HTML (North America)

External DLT VS Tape Drives

HP StorageWorks DLT VS 40/80 Tape Drive, External (Carbon) (NA)	280129-B22
HP StorageWorks DLT VS 40/80 Tape Drive, External (Carbon) (Int'l)	280129-B31
HP StorageWorks DLT VS 40/80 Tape Drive, External (Carbon) (Japan)	280129-291

NOTE: Please see the DLT VS 40/80 Tape Drive QuickSpecs for additional options such as host bus adapters, controllers, cassettes, and for an up-to-date listing of the latest O/S Support details, please see the following:

http://www5.compaq.com/products/quickspecs/11403_div/11403_div.HTML (Division/World Wide)
http://www5.compaq.com/products/quickspecs/11403_na/11403_na.HTML (North America)

HP StorageWorks Rackmount SDLT 110/220, 3U (Single Drive)	274331-B21
HP StorageWorks Rackmount SDLT 110/220, Dual-Drive, 3U (Two Drives)	274334-B21
HP StorageWorks Rackmount SDLT 110/220, Tape Array III, 5U (Four Drives)	274336-B21

NOTE: Please see the SDLT 110/220-GB Tape Drive QuickSpecs for additional options such as adapters, controllers, and media, and for an up-to-date listing of the latest O/S Support details, please see the following:

http://www5.compaq.com/products/quickspecs/10772_div/10772_div.HTML (Division/World Wide)
http://www5.compaq.com/products/quickspecs/10772_na/10772_na.HTML (North America)

HP StorageWorks SDLT 160/320, External NA (carbon)	257319-001
HP StorageWorks SDLT 160/320, External WW (carbon)	257319-B31
HP StorageWorks SDLT 160/320, External Japan (carbon)	257319-291

NOTE: Please see the SDLT 160/320-GB Tape Drive QuickSpecs for additional options such as adapters, controllers, and media, and for an up-to-date listing of the latest O/S Support details, please see the following:

http://www5.compaq.com/products/quickspecs/11406_div/11406_div.HTML (Division/World Wide)
http://www5.compaq.com/products/quickspecs/11406_na/11406_na.HTML (North America)

External SuperLoader

DLT1 1280 SuperLoader	268664-B21
-----------------------	------------

NOTE: Please see the StorageWorks DLT1 1280 SuperLoader QuickSpecs for additional options and for an up-to-date listing of the latest O/S Support details, please see the following:

http://www5.compaq.com/products/quickspecs/11330_div/11330_div.HTML (Division/World Wide)
http://www5.compaq.com/products/quickspecs/11330_na/11330_na.HTML (North America)

Options

Tape Drives (continued)

External LTO Ultrium Tape Drives

HP StorageWorks LTO Ultrium 230 Tape Drive, External (Carbon) NA	Q1516A
HP StorageWorks LTO Ultrium 230 Tape Drive, External (Carbon) Int'l	Q1517A

NOTE: Please see the HP StorageWorks LTO Ultrium Tape Drive QuickSpecs for additional options such as controllers, and other related items, and for an up-to-date listing of the latest O/S Support details, please see the following:

http://www5.compaq.com/products/quickspecs/11415_div/11415_div.HTML (Division/World Wide)
http://www5.compaq.com/products/quickspecs/11415_na/11415_na.HTML (North America)

HP StorageWorks Ultrium 460 Tape Drive for ProLiant, External (Carbon) NA	Q1519A
HP StorageWorks Ultrium 460 Tape Drive for ProLiant, External (Carbon) Int'l	Q1520A

NOTE: Please see the HP StorageWorks Ultrium 460 Tape Drives for ProLiant QuickSpecs for additional options such as data and cleaning cartridges, and for an up-to-date listing of the latest O/S Support details, please see the following:

http://www5.compaq.com/products/quickspecs/11530_div/11530_div.HTML (Division/World Wide)
http://www5.compaq.com/products/quickspecs/11530_na/11530_na.HTML (North America)

External DAT Autoloader

20/40-GB DAT 8 Cassette Autoloader External (Opal)	166505-001
20/40-GB DAT 8 Cassette Autoloader External (Opal) (Int'l)	166505-B31
20/40-GB DAT 8 Cassette Autoloader External (Opal) (Japan)	166505-291

NOTE: Please see the 20/40-GB DAT DDS-4 8 Cassette Autoloader QuickSpecs for additional options such as adapters, controllers, and cassettes, and for an up-to-date listing of the latest O/S Support details, please see the following:

http://www5.compaq.com/products/quickspecs/10518_div/10518_div.HTML (Division/World Wide)
http://www5.compaq.com/products/quickspecs/10518_na/10518_na.HTML (North America)

AIT Autoloader

HP StorageWorks AIT 35 GB Autoloader, Rackmount (Carbon) (NA)	280349-001
HP StorageWorks AIT 35 GB Autoloader, Rackmount (Carbon) (Int'l)	280349-B31

NOTE: Please see the AIT 35-GB Autoloader QuickSpecs for additional options such as adapters, controllers, and cassettes, and for an up-to-date listing of the latest O/S Support details, please see the following:
http://www5.compaq.com/products/quickspecs/11404_div/11404_div.HTML (Division/World Wide)
http://www5.compaq.com/products/quickspecs/11404_na/11404_na.HTML (North America)

HP StorageWorks 1/8 Autoloader

HP StorageWorks 1/8 Autoloader, Tabletop, Ultrium 230	C9572CB
HP StorageWorks 1/8 Autoloader, Tabletop, DLT VS80	C9264CB
HP StorageWorks 1/8 Autoloader, Rackmount kit	C9266R

Rackmount Tape Drive Kits

3U Rackmount Kit	274338-B21
------------------	------------

NOTE: The 3U Rackmount Kit (PN 274338-B21) can support up to (2) full-height or (4) half-height tape drives and compatible with multiple Single-Ended and LVD SCSI Tape Drives including the 12/24-GB DAT, 20/40-GB DAT, 20/40-GB DAT DDS-4 8 Cassette Autoloader, AIT 35-GB LVD, AIT 50 GB, 20/40-GB DLT, 40/80-GB DLT, and the SDLT 110/220-GB Tape Drives.

5U Rackmount Kit	274339-B21
------------------	------------

NOTE: The 5U Rackmount Kit (PN 274339-B21) can support up to (4) full-height tape drives and is compatible with all Compaq DLT/SDLT tape drives including the 20/40-GB DLT, 35/70-GB DLT, 40/80-GB DLT, and the SDLT 110/220-GB tape drives.

NOTE: Please see the Rackmount Tape Drive Kits QuickSpecs for additional information regarding these kits, please see the following:

http://www5.compaq.com/products/quickspecs/10854_div/10854_div.HTML (Division/World Wide)
http://www5.compaq.com/products/quickspecs/10854_na/10854_na.HTML (North America)

Options

Tape Drives *(continued)*

Rackmount Tape Drive Cable Kits

LVD Cable Kit, VHDCI/HD68	168048-B21
NOTE: For use with the 3U RM Storage Enclosure and DLT Tape Array III only.	
LVD Cable Kit, HD68/HD68	242381-B21
NOTE: For use with the 3U RM Storage Enclosure and DLT Tape Array III only.	

Tape Automation

Entry Level Tape Libraries

SSL2020 Automated AIT Library

SSL2020 AIT Mini-Library 1 drive, 20 slot Rackmount	175196-B21
SSL2020 AIT Mini-Library 2 drive, 20 slot Rackmount	175196-B22
SSL2020 AIT Library Pass Thru with Transport	175312-B21
SSL2020 AIT Library Pass Thru Extender	175312-B22
AIT 50-GB Drive Add-On LVD Drive for SSL2020 AIT Library	175197-B21

Required Adapters/Controllers for SSL2020 AIT Library

64-Bit/66-Mhz Dual Channel Wide Ultra3 SCSI Adapter	129803-B21
SAN Access Module for Smart Array 5302 Controller	216687-B21
SAN Access Module for Smart Array 5302 Controller (Japan)	216687-291

NOTE: Please see the SSL2020 Automated AIT Tape Library Solution QuickSpecs for additional information including Upgrade Kits, Accessories, and SCSI Cable Kits and additional options needed for a complete solution at:

http://www5.compaq.com/products/quickspecs/10580_na/10580_na.HTML (North America)

http://www5.compaq.com/products/quickspecs/10580_div/10580_div.HTML (Division/World Wide)

MSL5000 Libraries

Mainstream Tape Library

MSL5026DLX DLT Library

MSL5026DLX, 1 40/80-GB DLT, LVD Rackmount	231891-B21
MSL5026DLX, 2 40/80-GB DLT, LVD Rackmount	231891-B22

MSL5026SL SDLT Library

MSL5026SL, Rackmount, 1 SDLT Drive (Graphite)	302512-B21
MSL5026SL, Rackmount, 2 SDLT Drive (Graphite)	302512-B22

NOTE: Please see the StorageWorks MSL5026SL Library QuickSpecs for additional information including Upgrade Kits, Accessories, and SCSI Cable Kits and additional options needed for a complete solution at:

http://www5.compaq.com/products/quickspecs/11440_na/11440_na.HTML (North America)

http://www5.compaq.com/products/quickspecs/11440_div/11440_div.HTML (Division/World Wide)

MSL5026S2 SDLT Library

MSL5026S2, Rackmount, 0 Drive Library	293472-B21
MSL5026S2, Rackmount, 1 Drive, SDLT2 Library	293472-B22
MSL5026S2, Rackmount, 2 Drives, SDLT2 Library	293472-B23
MSL5026S2FC, Rackmount, 1 Drive, SDLT2 Library	293472-B24
MSL5026S2FC, Rackmount, 2 Drives, SDLT2 Library	293472-B25
MSL5026S2, Tabletop, 1 Drive, SDLT2 Library	293473-B21
MSL5026S2, Tabletop, 2 Drives, SDLT2 Library	293473-B22

NOTE: Please see the StorageWorks MSL5026S2 Library QuickSpecs for additional information including Upgrade Kits, Accessories, and SCSI Cable Kits and additional options needed for a complete solution at:

http://www5.compaq.com/products/quickspecs/11453_na/11453_na.HTML (North America)

http://www5.compaq.com/products/quickspecs/11453_div/11453_div.HTML (Division/World Wide)

Options

Tape Automation (continued)

MSL5000 Libraries (continued)

Departmental Tape Library

MSL5052SL SDLT Library

MSL5052, Rackmount, 0 Drive, SDLT ALL	255102-B21
---------------------------------------	------------

MSL50502SL, SDLT, 110/220, 2 Drives, LVD, Rackmount	249491-B21
---	------------

NOTE: Please see the StorageWorks MSL5052SL Library QuickSpecs for additional information including Upgrade Kits, Accessories, and SCSI Cable Kits and additional options needed for a complete solution at:
http://www5.compaq.com/products/quickspecs/11061_na/11061_na.HTML (North America)
http://www5.compaq.com/products/quickspecs/11061_div/11061_div.HTML (Division/World Wide)

MSL5052S2 SDLT Library

MSL5052S2, Rackmount, 2 Drives, SDLT2 Library	293474-B21
---	------------

MSL5052S2FC, Rackmount, 2 Drives, SDLT2 Library	293474-B24
---	------------

NOTE: Please see the StorageWorks MSL5052S2 Library QuickSpecs for additional information including Upgrade Kits, Accessories, and SCSI Cable Kits and additional options needed for a complete solution at:
http://www5.compaq.com/products/quickspecs/11442_na/11442_na.HTML (North America)
http://www5.compaq.com/products/quickspecs/11442_div/11442_div.HTML (Division/World Wide)

MSL5030 LTO Library

MSL5030L1, Rackmount, 0 Drive Library	301897-B21
---------------------------------------	------------

MSL5030L1, Rackmount, 1 Drive, LTO1 Library	301897-B22
---	------------

MSL5030L1, Rackmount, 2 Drives, LTO1 Library	301897-B23
--	------------

MSL5030L1FC, Rackmount, 1 Drive, LTO1 Library	301897-B24
---	------------

MSL5030L1FC, Rackmount, 2 Drives, LTO1 Library	301897-B25
--	------------

NOTE: Please see the StorageWorks MSL5030 LTO Library QuickSpecs for additional information including Upgrade Kits, Accessories, and SCSI Cable Kits and additional options needed for a complete solution at:
http://www5.compaq.com/products/quickspecs/11439_na/11439_na.HTML (North America)
http://www5.compaq.com/products/quickspecs/11439_div/11439_div.HTML (Division/World Wide)

MSL5060 LTO Library

MSL5060L1, Rackmount, 0 Drive Library	301899-B21
---------------------------------------	------------

MSL5060L1, Rackmount, 2 Drives, LTO1 Library	301899-B22
--	------------

MSL5060L1FC, Rackmount, 2 Drives, LTO1 Library	301899-B23
--	------------

NOTE: Please see the StorageWorks MSL5060 LTO Library QuickSpecs for additional information including Upgrade Kits, Accessories, and SCSI Cable Kits and additional options needed for a complete solution at:
http://www5.compaq.com/products/quickspecs/11438_na/11438_na.HTML (North America)
http://www5.compaq.com/products/quickspecs/11438_div/11438_div.HTML (Division/World Wide)

MSL5000 series Libraries Options

MSL5K Field Upgrade SDLT 110/220 Drive, LVD	231823-B22
---	------------

MSL5000 SDLT2 Upgrade Drive	293475-B21
-----------------------------	------------

MSL5000 LTO1 Upgrade Drive	301901-B21
----------------------------	------------

MSL5000 Dual Magazine LTO	301902-B21
---------------------------	------------

MSL5000 Dual Magazine DLT	232136-B21
---------------------------	------------

Required Adapters for MSL5000 series Libraries

64-Bit/66-Mhz Dual Channel Wide Ultra3 SCSI Adapter	129803-B21
---	------------

Options

Tape Automation *(continued)*

Enterprise 9000 System Library

ESL9322S2 SDLT Library

ESL9322S2, 222 slot, 2 Drives, SDLT2	293409-B22
ESL9322S2, 222 slot, 8 Drives, SDLT2	293409-B28
ESL9322S2, 322 slot, 2 Drives, SDLT2	293410-B22
ESL9322S2, 322 slot, 8 Drives, SDLT2	293410-B28

NOTE: Please see the StorageWorks ESL9322S2 Enterprise Library QuickSpecs for additional information including Tape Drives, Cartridges, Controllers, and SCSI Cables and additional options needed for a complete solution at:

http://www5.compaq.com/products/quickspecs/11437_na/11437_na.HTML (North America)
http://www5.compaq.com/products/quickspecs/11437_div/11437_div.HTML (World Wide)

ESL9322L1 SDLT Library

ESL9322L1, 222 slot, 2 Drives, LTO1	301927-B22
ESL9322L1, 222 slot, 8 Drives, LTO1	301927-B28
ESL9322L1, 322 slot, 2 Drives, LTO1	301928-B22
ESL9322L1, 322 slot, 8 Drives, LTO1	301928-B28

NOTE: Please see the StorageWorks ESL9322L1 Enterprise Library QuickSpecs for additional information including Tape Drives, Cartridges, Controllers, and SCSI Cables and additional options needed for a complete solution at:

http://www5.compaq.com/products/quickspecs/11445_na/11445_na.HTML (North America)
http://www5.compaq.com/products/quickspecs/11445_div/11445_div.HTML (World Wide)

ESL9595SL SDLT Library

ESL9595SL Enterprise Library, 400 slot, 16 Drive	274672-B22
ESL9595SL Enterprise Library, 500 slot, 2 Drive	281627-B22

NOTE: Please see the StorageWorks ESL9595SL Enterprise Library QuickSpecs for additional information including Tape Drives, Cartridges, Controllers, and SCSI Cables and additional options needed for a complete solution at:

http://www5.compaq.com/products/quickspecs/11332_na/11332_na.HTML (North America)
http://www5.compaq.com/products/quickspecs/11332_div/11332_div.HTML (World Wide)

ESL9595S2 SDLT Library

ESL9595S2, 400 slot, 2 Drives, SDLT2	293411-B22
ESL9595S2, 400 slot, 16 Drives, SDLT2	293411-B28
ESL9595S2, 500 slot, 2 Drives, SDLT2	293412-B22
ESL9595S2, 500 slot, 16 Drives, SDLT2	293412-B28
ESL9595S2, 595 slot, 2 Drives, SDLT2	293413-B22
ESL9595S2, 595 slot, 16 Drives, SDLT2	293413-B28

NOTE: Please see the StorageWorks ESL9595S2 Enterprise Library QuickSpecs for additional information including Tape Drives, Cartridges, Controllers, and SCSI Cables and additional options needed for a complete solution at:

http://www5.compaq.com/products/quickspecs/11436_na/11436_na.HTML (North America)
http://www5.compaq.com/products/quickspecs/11436_div/11436_div.HTML (World Wide)

Options

Tape Automation <i>(continued)</i>	Enterprise 9000 System Library <i>(continued)</i>	
	ESL9595L1 SDLT Library	
	ESL9595L1, 400 slot, 2 Drives, LTO1	301929-B22
	ESL9595L1, 400 slot, 16 Drives, LTO1	301929-B28
	ESL9595L1, 500 slot, 2 Drives, LTO1	301931-B22
	ESL9595L1, 500 slot, 16 Drives, LTO1	301931-B28
	ESL9595L1, 595 slot, 2 Drives, LTO1	301932-B22
	ESL9595L1, 595 slot, 16 Drives, LTO1	301932-B28
	NOTE: Please see the StorageWorks ESL9595L1 Enterprise Library QuickSpecs for additional information including Tape Drives, Cartridges, Controllers, and SCSI Cables and additional options needed for a complete solution at: http://www5.compaq.com/products/quickspecs/11435_na/11435_na.HTML (North America) http://www5.compaq.com/products/quickspecs/11435_div/11435_div.HTML (World Wide)	
	ESL9000 series Libraries Options	
	ESL9000 Field Upgrade SDLT 110/220, LVD Drive (ESL9198SL, ESL9326SL, ESL9595SL)	234617-B21
	ESL9595 500 Slot Upgrade	274674-B21
	ESL9595 595 Slot Upgrade	274674-B22
	ESL9000 LTO1 Upgrade Drive	301930-B21
	ESL9000 LVD SDLT-160 Drive Upgrade	293414-B21
	ESL9000 HVD SDLT-160 Drive Upgrade	293415-B21
	ESL9000 Universal Load Port	302254-B21
	ESL9322 222 Slot to ESL9322 322 Slot Upgrade	293588-B21
	ESL9000 6 Slot DLT Magazine	229909-B21
	Required Adapters for ESL9000 Libraries	
	64-Bit/66-Mhz Dual Channel Wide Ultra3 SCSI Adapter	129803-B21
	NOTE: 64-Bit/66-Mhz Dual Channel Wide Ultra3 SCSI Adapter is required to support the LVD based libraries (ESL9595SL).	
Smart Array Cluster Storage	Smart Array Cluster Storage	201724-B21
	Smart Array Cluster Storage Redundant Controller Option Kit	218252-B21
	128-MB Cache Module for Smart Array 5302 Controller	153506-B21
	256-MB Battery-Backed Cache Module	254786-B21
	4-Port Shared Storage Module with Smart Array Multipath Software for Smart Array Cluster Storage	292944-B21
	NOTE: Please see the Compaq Smart Array Cluster Storage QuickSpecs for additional information including configuration steps and additional options needed for a complete solution at: http://www5.compaq.com/products/quickspecs/11050_na/11050_na.html (North America) http://www5.compaq.com/products/quickspecs/11050_div/11050_div.html (Division/World Wide)	

Options

Cluster Options	Compaq ProLiant Cluster HA/F100 for Windows NT and 2000 Advanced Server	309816-B21
	Compaq ProLiant Cluster HA/F200 Upgrade Kit (NT 4.0EE to W2K AS)	176848-B22
	Compaq ProLiant Cluster HA/F200 for Windows NT and 2000 Advanced Server	380357-B23
	Compaq ProLiant Cluster HA/F200 for Windows NT and 2000 Advanced Server (Japan)	380357-293
	NOTE: For additional information regarding the Compaq ProLiant Cluster for HA/F100, HA/F200 for Windows NT and 2000 Advanced Server please see the following QuickSpecs at: http://www5.compaq.com/products/quickspecs/10777_na/10777_na.html (North America) http://www5.compaq.com/products/quickspecs/10777_div/10777_div.html (Division/World Wide)	
	ProLiant Cluster HA/F500 Basic Kit for MA8000/EMA16000	103250-B25
	ProLiant Cluster HA/F500 Enhanced Kit for MA8000/EMA16000	379937-B25
	ProLiant Cluster HA/F500 Enhanced DT Kit for MA8000/EMA16000	164227-B23
	NOTE: For additional information regarding the Compaq ProLiant Cluster for HA/F500 please see the following QuickSpecs at: http://www5.compaq.com/products/quickspecs/10232_na/10232_na.html (North America) http://www5.compaq.com/products/quickspecs/10232_div/10232_div.html (Division/World Wide)	
	ProLiant Cluster HA/F500 Enhanced Kit for Enterprise Virtual Array v.2	254623-B22
	ProLiant Cluster HA/F500 Basic Kit for Enterprise Virtual Array (v.2)	313047-B21
	NOTE: For additional information regarding the Compaq ProLiant Cluster HA/F500 for Enterprise Virtual Array please see the following QuickSpecs at: http://www5.compaq.com/products/quickspecs/11055_na/11055_na.html (North America) http://www5.compaq.com/products/quickspecs/11055_div/11055_div.html (Division/World Wide)	
	ProLiant Cluster HA/F100 for MSA1000 v2	252408-B22
	ProLiant Cluster HA/F100 for MSA1000 v2 (Japan)	252408-292
	ProLiant Cluster HA/F200 for MSA1000 v2	252409-B22
ProLiant Cluster HA/F200 for MSA1000 v2 (Japan)	252409-292	
ProLiant Cluster HA/L100 LifeKeeper for Linux	303523-B21	
NOTE: For additional information regarding the ProLiant Cluster HA/L100 LifeKeeper for Linux, please see the following QuickSpecs at: http://www5.compaq.com/products/quickspecs/11533_na/11533_na.html (North America) http://www5.compaq.com/products/quickspecs/11533_div/11533_div.html (Division/World Wide)		
External Storage - Rack	StorageWorks Enclosure Model 4314R (rack-mountable)	190209-001
	StorageWorks Enclosure Model 4314R (rack-mountable) (Int'l)	190209-B31
	StorageWorks Enclosure Model 4314R (rack-mountable) (Japan)	190209-291
	StorageWorks Enclosure Model 4354R (rack-mountable)	190211-001
	StorageWorks Enclosure Model 4354R (rack-mountable) (Int'l)	190211-B31
	StorageWorks Enclosure Model 4354R (rack-mountable) (Japan)	190211-291
	NOTE: The StorageWorks Enclosure 4300 Family support the Wide Ultra2/Ultra3 1" Hot Plug Hard Drives.	
	StorageWorks Enclosure 4200 Redundant Power Supply Option	119826-B21
	StorageWorks Enclosure 4200 Ultra3 Single Bus I/O Module Option	190212-B21
	StorageWorks Enclosure 4200 Ultra3 Dual Bus I/O Module Option	190213-B21
	StorageWorks Enclosure Tower to Rack Conversion Kit	150213-B21
	MSA1000	MSA 1000
MSA 1000 Controller		218231-B22
MSA Fibre Channel I/O Module		218960-B21
MSA1000 Fabric Switch		218232-B21
MSA 1000 Fibre Channel Adapter (FCA) 2101		245299-B21
HP StorageWorks msa hub 2/3		286763-B21
NOTE: Please see the HP StorageWorks modular SAN array 1000 QuickSpecs for additional options and configuration information at: http://www5.compaq.com/products/quickspecs/11033_na/11033_na.HTML (North America) http://www5.compaq.com/products/quickspecs/11033_div/11033_div.HTML (Division/World Wide)		

Options

StorageWorks Modular Array 8000/Enterprise Modular Array 12000	EMA12000 D14 60 Hz	175990-B21
	EMA12000 D14 50 Hz	175990-B22
	EMA12000 S14 60 Hz	175991-B21
	EMA12000 S14 50 Hz	175991-B22
	MA8000 60 Hz	175992-B21
	MA8000 50 Hz	175992-B22
	EMA12000 Blue 60 Hz	175993-B21
	EMA12000 Blue 50 Hz	175993-B22
NOTE: Options include controller, solution kits, ACS. MA8000/EMA12000 includes controller shelf, drive shelves and cabinet. Packaging upgrade to RA8000/ESA12000.		
NOTE: Please see the StorageWorks MA8000/EMA12000 QuickSpecs for FC Hubs, FC switches, platform software, host adapters, disks and options for complete solutions at: http://www5.compaq.com/products/quickspecs/10545_na/10545_na.HTML (North America) http://www5.compaq.com/products/quickspecs/10545_div/10545_div.HTML (Division/World Wide)		
StorageWorks Enterprise Modular Array 16000 FC	EMA16000 D14 50Hz (opal)	238792-B22
	EMA16000 D14 60Hz (opal)	238792-B21
	EMA16000 S14 50Hz (opal)	238791-B22
	EMA16000 S14 60Hz (opal)	238791-B21
NOTE: Models include: Dual HSG80 controllers in each Model 2200 enclosure (2 pairs per single bus configuration, 4 pairs per dual bus configuration) with 1GB cache per controller pair, and 12 14-bay drive enclosures with redundant power supplies. Configure-to-Order (CTO) builds are available. Options include ACS, platform kits and software by HP.		
NOTE: Please see the StorageWorks EMA16000 QuickSpecs for FC switches, platform software, host adapters, disks and options for complete solutions at: http://www5.compaq.com/products/quickspecs/10812_na/10812_na.HTML (North America) http://www5.compaq.com/products/quickspecs/10812_div/10812_div.HTML (Division/World Wide)		
StorageWorks Options	StorageWorks SAN Switch 2/8-EL	258707-B21
	StorageWorks SAN Switch 2/8-EL Upgrade	288162-B21
	StorageWorks SAN Switch 2/16-EL	283056-B21
	StorageWorks SAN Switch 2/16-EL Upgrade	288250-B21
UPS and PDU Power Cord Matrix	<i>Please see the UPS and PDU cable matrix that lists cable descriptions, requirements, and specifications for UPS and PDU units.that lists cable descriptions, requirements, and specifications for UPS units.</i> ftp://ftp.compaq.com/pub/products/servers/ProLiantstorage/power-protection/powercordmatrix.pdf .	
Uninterruptible Power Systems – Rack	Compaq UPS R1500 XR (1440VA, 1340 Watt), Low Voltage (NA)	204404-001
	Compaq UPS R1500 XR (1500VA, 1340 Watt), High Voltage (Int'l)	204404-B31
	Compaq UPS R1500 XR (1500VA, 1340 Watt), Low Voltage (Japan)	204404-291
	Compaq UPS R3000 XR (2880VA, 2700 Watt), Low Voltage (NA)	192186-001
	Compaq UPS R3000 XR (3000VA, 2700 Watt), High Voltage (NA)	192186-002
	Compaq UPS R3000 XR (2400VA, 2250 Watt), Low Voltage (Japan)	192186-291
	Compaq UPS R3000 XR (3000VA, 2700 Watt), High Voltage (Japan)	192186-292
	Compaq UPS R3000 XR (3000VA, 2700 Watt), High Voltage (Int'l - detachable cord)	192186-B31
	Compaq UPS R3000 XR (3000VA, 2700 Watt), High Voltage (16A IEC309 Plug)	192186-B32
	Compaq UPS R3000 XR (3000VA, 2700 Watt), High Voltage (16A CEE 7/7 SCHUKO Plug)	192186-B33
	Compaq UPS R3000 XR (3000VA, 2700 Watt), High Voltage (16A BS-546 Plug)	192186-AR1
	Rack-Mountable UPS R6000 (6000VA, 6000 Watt) High Voltage (NA)	347207-001
	Rack-Mountable UPS R6000 (6000VA, 6000 Watt) High Voltage (Int'l)	347207-B31
	Rack-Mountable UPS R6000 (6000VA, 6000 Watt) High Voltage (Japan)	347207-291
UPS R12000 XR N+x (200-240V) (WW-hardwired)	207552-B22	

Options

UPS Options	SNMP Serial Port Card	192189-B21
	NOTE: Supports tower and rack UPS XR models ranging from 1000 – 3000VA.	
	Six Port Card	192185-B21
	NOTE: Supports tower and rack UPS XR models ranging from 1000 – 3000VA.	
	High to Low Voltage Transformer (250VA)	388643-B21
	NOTE: Supports R6000 UPS series only. 2.5 amps @ 125 Volts max output across two Nema 5-15.	
	Extended Runtime Module, R1500 XR	218971-B21
	NOTE: 2U each, two ERM maximum.	
	Extended Runtime Module, R3000 XR	192188-B21
	NOTE: 3U each, one ERM maximum.	
	Extended Runtime Module, R6000	347224-B21
	NOTE: 3U each, two ERM maximum.	
Extended Runtime Module, R12000 XR, 4U	217800-B21	
NOTE: 4U each, two ERM maximum.		
SNMP-EN Adapter	347225-B21	
NOTE: Supports R6000 UPS series only.		
Multi-Server UPS Card	123508-B21	
NOTE: Supports R6000 UPS series only.		
Scalable UPS Card	123509-B21	
NOTE: Supports R6000 UPS series only.		
Rack-Mountable PDUs – 1U/0U (Up to 12 outlets) NOTE: 0U mounting brackets shipped with the unit (separate option kit for 1U mounting).	Compaq Power Distribution Unit-16A (200 to 240V) (WW)	207590-B21
	NOTE: The 16A PDU also connects to the high volt models of the UPS R3000 XR (need cable PN 340653-001 (NA)) and the UPS R6000 models. Cable PN 340653-001 required if connecting to UPS R3000 XR (192186-002 NA-High Volt model only).	
	Compaq Power Distribution Unit-32A (200 to 240V) (Int'l)	207590-B31
	Compaq Power Distribution Unit-40A (200 to 240V) (WW)	207590-B23
	NOTE: Please see the following Power Distribution Unit (Zero-U/1U PDU) QuickSpecs for additional options including cables: http://www5.compaq.com/products/quickspecs/10838_na/10838_na.HTML (North America) http://www5.compaq.com/products/quickspecs/10838_div/10838_div.HTML (Division/World Wide)	
Modular PDUs 1U/0U (Up to 32 outlets)	HP Modular Power Distribution Units (mPDU), Low Volt Model, 24A (100-127 VAC) (NA, Japan)	252663-D71
	HP Modular Power Distribution Units (mPDU), High Volt Model, 24A (200-240 VAC) (NA, Japan)	252663-D72
	HP Modular Power Distribution Units (mPDU), High Volt Model, 32A (200-240 VAC) (Int'l)	252663-B31
	HP Modular Power Distribution Units (mPDU), High Volt Model, 40A (200-240 VAC) (WW)	252663-B21
	HP Modular Power Distribution Units (mPDU), High Volt Model, 16A (200-240 VAC) (WW)	252663-B24
	NOTE: This PDU has a detachable input power cord and allows for adaptability to country specific power requirements. This model may also be used with the high volt UPSs R3000 XR and R6000.	
NOTE: Please see the following Modular Power Distribution Unit (Zero-U/1U Modular PDUs) QuickSpecs for additional options including shorter jumper cables and country specific power cords: http://www5.compaq.com/products/quickspecs/11041_na/11041_na.HTML (North America) http://www5.compaq.com/products/quickspecs/11041_div/11041_div.HTML (Division/World Wide)		

Options

PDU Options	1U PDU Mounting Brackets Kit	215852-B21	
	NOTE: The 1U PDU Mounting Brackets are required when mounting PDU's PN 207590-xxx series in 1U configurations.		
	Third Party PDU Mounting Kit	310777-B21	
	NOTE: This kit allows you to mount the Modular PDUs in racks other than the 9000/10000 Series racks (any racks using the standard 19" rail). For more details please refer the Modular PDU QuickSpecs.		
Rack Builder	Rack Builder for configuration assistance at http://www.compaq.com/rackbuilder/		
HP Rack 10000 Series (Graphite Metallic)	HP Rack 10842 (42U, 800mm wide) – Pallet	257415-B21	
	HP Rack 10842 (42U, 800mm wide) – Shock Pallet	257415-B22	
	NOTE: Not available in North America.		
	HP Rack 10647 (47U) – Pallet	245160-B21	
	HP Rack 10647 (47U) – Crated	245160-B23	
	HP Rack 10642 (42U) – Pallet	245161-B21	
	HP Rack 10642 (42U) – Shock Pallet	245161-B22	
	HP Rack 10642 (42U) – Crated	245161-B23	
	HP Rack 10636 (36U) – Pallet	245162-B21	
	HP Rack 10636 (36U) – Shock Pallet	245162-B22	
	HP Rack 10636 (36U) – Crated	245162-B23	
	HP Rack 10622 (22U) – Pallet	245163-B21	
	HP Rack 10622 (22U) – Shock Pallet	245163-B22	
	HP Rack 10622 (22U) – Crated	245163-B23	
	NOTE: -B21 (pallet) used to ship empty racks shipped on a truck -B22 (shock pallet) used to ship racks with equipment installed (by custom systems, VARs and Channels) -B23 (crated) used for air shipments of empty racks		
	NOTE: Please see the Rack 10000 QuickSpecs for Technical Specifications such as height, width, depth, weight, and color: http://www5.compaq.com/products/quickspecs/10995_div/10995_div.HTML (Division/World Wide) http://www5.compaq.com/products/quickspecs/10995_na/10995_na.HTML (North America)		
NOTE: For additional information regarding Rack Cabinets, please see the following URL: http://www.compaq.com/racks			
Compaq Rack 9000 Series (opal)	Compaq Rack 9142 (42U) – Pallet	120663-B21	
	Compaq Rack 9142 (42U) – Shock Pallet	120663-B22	
	Compaq Rack 9142 (42U) – Crated	120663-B23	
	Compaq Rack 9136 (36U) – Pallet	120664-B21	
	Compaq Rack 9136 (36U) – Shock Pallet	120664-B22	
	Compaq Rack 9136 (36U) – Crated	120664-B23	
	Compaq Rack 9122 (22U) – Pallet	120665-B21	
	Compaq Rack 9122 (22U) – Shock Pallet	120665-B22	
	Compaq Rack 9122 (22U) – Crated	120665-B23	
	Compaq Rack 9842 (800mm wide, 42U) – Pallet	222192-B21	
	NOTE: -B21 (pallet) used to ship empty racks shipped on a truck -B22 (shock pallet) used to ship racks with equipment installed (by custom systems, VARs and Channels) -B23 (crated) used for air shipments of empty racks		
	NOTE: Please see the Rack 9000 QuickSpecs for Technical Specifications such as height, width, depth, weight, and color: http://www5.compaq.com/products/quickspecs/10366_div/10366_div.HTML (Division/World Wide) http://www5.compaq.com/products/quickspecs/10366_na/10366_na.HTML (North America)		
NOTE: For additional information regarding Rack Cabinets, please see the following URL: http://www.compaq.com/racks			

Options

Rack Options for HP Rack 10000 Series	Rack Blanking Panels – Graphite (Multi)	253214-B26
	NOTE: Contains one each of 1U, 2U, 3U, and 4U panel.	
	Rack Blanking Panels – Graphite (1U)	253214-B21
	NOTE: The Rack Blanking Panels (PN 253214-B21) contains 10 each of (1U).	
	Rack Blanking Panels – Graphite (2U)	253214-B22
	NOTE: The Rack Blanking Panels (PN 253214-B21) contains 10 each of (2U).	
	Rack Blanking Panels – Graphite (3U)	253214-B23
	NOTE: The Rack Blanking Panels (PN 253214-B21) contains 10 each of (3U).	
	Rack Blanking Panels – Graphite (4U)	253214-B24
	NOTE: The Rack Blanking Panels (PN 253214-B21) contains 10 each of (4U).	
	Rack Blanking Panels – Graphite (5U)	253214-B25
	NOTE: The Rack Blanking Panels (PN 253214-B21) contains 10 each of (5U).	
	600mm Stabilizer Kit – Graphite	246107-B21
	800mm Wide Stabilizer Kit (Graphite)	255488-B21
	NOTE: Supported by the Rack 10842 cabinet only.	
	Baying Kit for Rack 10000 series (Carbon)	248929-B21
	42U Side Panel – Graphite Metallic	246099-B21
	110V Fan Kit (Graphite)	257413-B21
	NOTE: Roof Mount Includes power cord with IEC320-C13 to Nema 5-15P.	
	220V Fan Kit (Graphite)	257414-B21
NOTE: Roof Mount Includes power cord with IEC320-C13 to Nema 6-15P.		
36U Side Panel – Graphite Metallic	246102-B21	
47U Side Panel – Graphite Metallic	255486-B21	
9000/10000 Series Offset Baying Kit	248931-B21	
NOTE: This kit can be used to connect 9000 and 10000 series racks of the same U height together. Kit contents include hardware for connecting racks and a panel to cover the 100mm gap at the rear of the two racks.		
NOTE: For additional information regarding Rack Cabinets, please see the following URL: http://www.compaq.com/rackoptions		
Rack Options for Compaq Rack 9000 Series	Baying/Coupling Kit	120669-B21
	42U Side Panel	120670-B21
	NOTE: The 42U Side Panel (PN 120670-B21) supports the Compaq Rack 9142 and Compaq Rack 9842.	
	36U Side Panel	120671-B21
	NOTE: The 36U Side Panel (PN 120671-B21) supports the Compaq Rack 9136.	
	9142 Extension Kit	120679-B21
	NOTE: The 9142 Extension Kit (PN 120679-B21) supports the Compaq Rack 9142 only.	
	9136 Extension Kit	218216-B21
	9142 Split Rear Door	254045-B21
	NOTE: The 9142 Split Rear Door (PN 254045-B21) supports the 600 mm wide, 42U 9000 series rack.	
	9142 Short Rear Door	218217-B21
	NOTE: The 9142 Short Rear Door (PN 218217-B21) supports the Compaq Rack 9142 only.	
	9136 Short Rear Door	218218-B21
	9122 Short Rear Door (Opal)	218219-B21
	800mm Stabilizer Option Kit (Opal)	234493-B21
	NOTE: The 800mm Stabilizer Kit (PN 234493-B21) supports the Rack 9842 only.	
	600mm Stabilizer Option Kit	120673-B21
Rack Blanking Panel (Multi)	169940-B21	
NOTE: Kit includes four panels in 1U, 2U, 4U, and 8U.		

Options

Rack Options for Compaq Rack 9000 Series <i>(continued)</i>	Rack Blanking Panels (1U) NOTE: The Rack Blanking Panels (PN 189453-B21) contains 10 each of (1U).	189453-B21
	Rack Blanking Panels (2U) NOTE: The Rack Blanking Panels (PN 189453-B22) contains 10 each of (2U).	189453-B22
	Rack Blanking Panels (3U) NOTE: The Rack Blanking Panels (PN 189453-B23) contains 10 each of (3U).	189453-B23
	Rack Blanking Panels (4U) NOTE: The Rack Blanking Panels (PN 189453-B24) contains 10 each of (4U).	189453-B24
	Rack Blanking Panels (5U) NOTE: The Rack Blanking Panels (PN 189453-B25) contains 10 each of (5U).	189453-B25
	9000/10000 Series Offset Baying Kit NOTE: This kit can be used to connect 9000 and 10000 series racks of the same U height together. Kit contents include hardware for connecting racks and a panel to cover the 100mm gap at the rear of the two racks. NOTE: For additional information regarding Rack Cabinets, please see the following URL: http://www.compaq.com/rackoptions	248931-B21
	Rack Options for Rack 7000 Series	High Air Flow Rack Door Insert for 7122
	High Air Flow Rack Door Insert for 7142	327281-B21
	High Air Flow Rack Door Insert for 7142 (six pack)	327281-B22
	Compaq Networking Cable Management Kit	292407-B21
	Compaq Rack Extension Kit for 7142 NOTE: For additional information regarding Rack Cabinets, please see the following URL: http://www.compaq.com/rackoptions	154392-B21
Rack Options for Rack 7000, 9000 and 10000 Series	Monitor Utility Shelf	303606-B21
	Ballast Option Kit	120672-B21
	100kg Sliding Shelf	234672-B21
	Monitor/Utility Shelf - Graphite	253449-B21
	Depth Adjustable Fixed Rail	332558-B21
	Rack Rail Adapter Kit (25-inch depth)	120675-B21
	Cable Management D-Rings Kit	168233-B21
	Console Management Controller (CMC) Option Kit	203039-B21
	Console Management Controller (CMC) Sensors Option Kit	203039-B22
	Console Management Controller (CMC) Locking Option Kit	203039-B23
	Console Management Controller (CMC) Smoke Sensors Option Kit	203039-B24
	Server Console Switch 1 x 2 port (100 to 230 VAC)	120206-001
	Server Console Switch 1 x 2 port (100 to 230 VAC) (Int'l)	120206-B31
	Server Console Switch 1 x 2 port (100 to 230 VAC) (Japan)	120206-291
	Server Console Switch 1 x 4 port (100 to 230 VAC)	400336-001
	Server Console Switch 1 x 4 port (100 to 230 VAC) (Int'l)	400336-B31
	Server Console Switch 1 x 4 port (100 to 230 VAC) (Japan)	400336-291
	Server Console Switch 1 x 8 port (100 to 230 VAC)	400337-001
	Server Console Switch 1 x 8 port (100 to 230 VAC) (Int'l)	400337-B31
	Server Console Switch 1 x 8 port (100 to 230 VAC) (Japan)	400337-291
	Server Console Switch 1 x 2 port (100 to 230 VAC)	400338-001
	Server Console Switch 1 x 2 port (100 to 230 VAC) (Int'l)	400338-B31
	Server Console Switch 1 x 2 port (100 to 230 VAC) (Japan)	400338-291
	Server Console Switch 2 x 8 port (48 VDC)	400542-B21
	IP Console Switch Box, 1x1x16	262585-B21
	IP Console Switch Box, 3x1x16	262586-B21
	IP Console Interface Adapter, 8 pack	262587-B21

Options

Rack Options for Rack 7000, 9000 and 10000 Series <i>(continued)</i>	IP Console Interface Adapter, 1 pack	262588-B21		
	IP Console Expansion Module	262589-B21		
	KVM 9 PIN Adapter (4 Pack)	149361-B21		
	CPU to Server Console Cable, 12'	110936-B21		
	CPU to Server Console Cable, 20'	110936-B22		
	CPU to Server Console Cable, 40'	110936-B23		
	CPU to Server Console Cable, 3'	110936-B24		
	CPU to Server Console Cable, 7'	110936-B25		
	CPU to Server Console Cable (Plenum Rated) 20'	149363-B21		
	CPU to Server Console Cable (Plenum Rated) 40'	149364-B21		
	IP CAT5 Cable 3', 4 pack	263474-B21		
	IP CAT5 Cable 6', 8 pack	263474-B22		
	IP CAT5 Cable 12', 8 pack	263474-B23		
	IP CAT5 Cable 20', 4 pack	263474-B24		
	IP CAT5 Cable 40', 1 pack	263474-B25		
	Switch Box Connector Kit (115 V)	144007-001		
	Switch Box Connector Kit (230 V)	144007-002		
	Switch Box Connector Kit (high voltage) (Int'l)	144007-B33		
	1U Rack Keyboard & Drawer (Carbon)	257054-xx1		
	Country Code Key <i>(for 1U Rack Keyboard & Drawer (PN 257054-xx1))</i>			
	XX = 001	US	XX = 091	Norway
	XX = 031	UK	XX = 101	Sweden/Finland
	XX = 041	Germany	XX = 111	Switzerland
	XX = 051	France	XX = 131	Portugal
	XX = 061	Italy	XX = 181	Belgium
	XX = 071	Spain	XX = 291	Japan
	XX = 081	Denmark	XX = B31	International
	TFT5600 Rack Keyboard Monitor	221546-xx1		
	Country Code Key <i>(for TFT5600 RKM Rack Keyboard Monitor (PN 221546-xx1))</i>			
	XX = 001	US	XX = 091	Norway
	XX = 031	UK	XX = 101	Sweden/Finland
	XX = 041	Germany	XX = 111	Switzerland
	XX = 051	France	XX = 131	Portugal
XX = 061	Italy	XX = 181	Belgium	
XX = 071	Spain	XX = 291	Japan	
XX = 081	Denmark	XX = B31	International	
PCI KVM Management Card Kit	232983-B21			
PCI KVM Remote Card Kit	232984-B21			
Local Access Cable Kit	232985-B21			
Input Device Adjustable Rails	287139-B21			
NOTE: Input Device Adjustable Rails (287139-B21) are for use ONLY with the TFT5110R, TFT5600RKM and integrated keyboard/drawer which is used in mounting into third party racks.				
Input Device Telco Rail	287138-B21			
NOTE: Input Device Telco Rails (287138-B21) are for use ONLY with the TFT5110R, TFT5600RKM and integrated keyboard/drawer which is used in mounting into third party racks.				
Keyboard/Monitor/Mouse extension cables	169989-001			
NOTE: For additional information regarding Rack Cabinets, please see the following URL: http://www.compaq.com/rackoptions				

Options

Service and Support Offerings (CarePaq Services)

Hardware Services 4-Hour On-site Service

4-Hour On-site Service, 5-Day x 9-Hour Coverage, 3 Years (6-3 Part Number for U.S.)	401783-002
4-Hour On-site Service, 5-Day x 9-Hour Coverage, 3 Years (6-3 Part Number for Canada)	401783-122
4-Hour On-site Service, 5-Day x 9-Hour Coverage, 3 Years (6-3 Part Number for EMEA)	324418-002
4-Hour On-site Service, 7-Day x 24-Hour Coverage, 3 Years (6-3 Part Number for U.S.)	401782-002
4-Hour On-site Service, 7-Day x 24-Hour Coverage, 3 Years (6-3 Part Number for Canada)	401782-122
4-Hour On-site Service, 7-Day x 24-Hour Coverage, 3 Years (6-3 Part Number for EMEA)	376911-022

Installation & Start-up Services

Hardware Installation (6-3 Part Number for U.S.)	401793-002
Hardware Installation (6-3 Part Number for Canada)	401793-122
Hardware Installation (6-3 Part Number for EMEA)	Quote
Pre-installation planning; unpack equipment, install most current Compaq HW options internal to server at same time of server installation; assemble & test; basic user information provided; Install & configure basic functionality of Win NT Operating System plus up to 1 day start-up activity, configure print & network access services, and orientation (6-3 Part Number for U.S.)	240015-002
Pre-installation planning; unpack equipment, install most current Compaq HW options internal to server at same time of server installation; assemble & test; basic user information provided; Install & configure basic functionality of Novell NetWare Operating System plus up to 1 day start-up activity, configure print & network access services, and orientation (6-3 Part Number for U.S.)	240010-002
Server Installation and Set-Up (Installation of the server, installation of the appropriate service tools, check to ensure device SW and firmware is loaded and installation of the operating system software (6-3 Part Number for EMEA)	204564-022

CarePaq Priority Services for ProLiant Servers - Priority Level

9 x 5 HW, 4-hr response, Next Available HW engineer; 9 x 5 Bronze Software Support 2-hr response for Windows NT, Windows 2000, Professional, Server or Advanced Server Operating System, Next Available Specialist (6-3 Part Number for U.S.)	239936-002
9 x 5 HW, 4-hr response, Next Available HW engineer; 9 x 5 Bronze Software Support 2-hr response for Novell NetWare Operating System, Next Available Specialist (6-3 Part Number for U.S.)	239976-002
5 x 9 4-hour H/W, 5 x 9 2-hour O/S (NT & NetWare), Three Years (6-3 Part Number for Canada)	155325-122
5 x 9 4-hour H/W, 5 x 9 2-hour O/S (NT & NetWare), Three Years (6-3 Part Number for EMEA)	118311-022

CarePaq Priority Services for ProLiant Servers - Priority 24 Level

24 x 7 HW, 4-hr response, Named HW engineer; 24 x 7 Bronze Software Support, 2-hr response for Windows NT, Windows 2000, Professional, Server or Advanced Server Operating System, Next Available Specialist (6-3 Part Number for U.S.)	239938-002
24 x 7 HW, 4-hr response, Named HW engineer; 24 x 7 Bronze Software Support, 2-hr response for Novell NetWare Operating System, Next Available Specialist (6-3 Part Number for U.S.)	239978-002
7 x 24 4-hour H/W, 7 x 24 2-hour O/S (NT & NetWare), Three years (6-3 Part Number for EMEA)	118317-022

CarePaq Priority Services for ProLiant Servers - Priority Plus Level

7 x 24 4-hour H/W, 7 x 24 1-hour O/S (NT & NetWare), SPS account review, Three Years (6-3 Part Number for Canada)	155333-122
---	------------

Options

Service and Support Offerings (CarePaq Services) (continued)

CarePaq Priority Services for ProLiant Servers - Priority Silver

24 x 7 HW, 4-hr response, Named HW engineer; 24 x 7 Silver Software Support, 1-hr response, Monday – Friday, 8AM – 5PM local time, 2-hr response after hours for Windows NT, Windows 2000, Professional, Server or Advanced Server Operating System, Technical Account Manager, Technical Newsletter, SW activity review, proactive patch notification, 1 System Healthcheck per year (6-3 Part Number for U.S.)	239940-002
24 x 7 HW, 4-hr response, Named HW engineer; 24 x 7 Silver Subsequent System Support for Windows NT, Windows 2000, Professional, Server or Advanced Server Operating System (6-3 Part Number for U.S.)	239942-002
24 x 7 HW, 4-hr response, Named HW engineer; 24 x 7 Silver Software Support, 1-hr response, Monday – Friday, 8AM – 5PM local time, 2-hr response after hours for Novell NetWare Operating System, Technical Account Manager, Technical Newsletter, SW activity review (6-3 Part Number for U.S.)	239980-002
24 x 7 HW, 4-hr response, Named HW engineer; 24 x 7 Silver Subsequent System Support for Novell NetWare Operating System (6-3 Part Number for U.S.)	239982-002

CarePaq Priority Services for ProLiant Servers - Priority Gold

24 x 7 HW, 4-hr response, Named HW engineer; 24 x 7 Gold Software Support, 30 minute response (critical), 1-hr response (non-critical), for Windows NT, Windows 2000, Professional, Server or Advanced Server Operating System, Technical Account Manager, Technical Newsletter, SW activity review, proactive revision management, Upgrade impact planning, 2 System Healthcheck per year (6-3 Part Number for U.S.)	239944-002
24 x 7 HW, 4-hr response, Named HW engineer; 24 x 7 Gold Subsequent System Support for Windows NT, Windows 2000, Professional, Server or Advanced Server Operating System (6-3 Part Number for U.S.)	239946-002
24 x 7 HW, 4-hr response, Named HW engineer; 24 x 7 Gold Software Support, 30 minute response (critical), 1-hr response (non-critical), for Novell NetWare Operating System, Technical Account Manager, Technical Newsletter, SW activity review, Upgrade impact planning (6-3 Part Number for U.S.)	239984-002
24 x 7 HW, 4-hr response, Named HW engineer; 24 x 7 Gold Subsequent System Support for Novell NetWare Operating System (6-3 Part Number for U.S.)	239986-002

CarePaq Priority Services for ProLiant Servers - Priority Gold Executive

24 x 7 HW, 2-hr response, Named HW engineer; 24 x 7 Gold Software Support, 30 minute response (critical), 1-hr response (non-critical), for Windows NT, Windows 2000, Professional, Server or Advanced Server Operating System, Technical Account Manager, Technical Newsletter, SW activity review, proactive revision management, Upgrade impact planning, 2 System Healthcheck per year (6-3 Part Number for U.S.)	239948-002
24 x 7 HW, 2-hr response, Named HW engineer; 24 x 7 Gold Subsequent System Support for Windows NT, Windows 2000, Professional, Server or Advanced Server Operating System (6-3 Part Number for U.S.)	239950-002
24 x 7 HW, 2-hr response, Named HW engineer; 24 x 7 Gold Software Support, 30 minute response (critical), 1-hr response (non-critical), for Novell NetWare Operating System, Technical Account Manager, Technical Newsletter, SW activity review, Upgrade impact planning (6-3 Part Number for U.S.)	239988-002
24 x 7 HW, 2-hr response, Named HW engineer; 24 x 7 Gold Subsequent System Support for Novell NetWare Operating System (6-3 Part Number for U.S.)	239990-002

CarePaq Priority Services for ProLiant Servers – Priority Premier Level

7 x 24 2-hour H/W, 7 x 24 1-hour O/S (NT & NetWare), SPS Account Review, Proactive Management Review, named S/w rep, Three Years (6-3 Part Number for Canada)	155337-122
---	------------

CarePaq Priority Services for ProLiant Servers – Priority Executive Premier Level

7 x 24 2-hour H/W, 7 x 24 30-minute O/S (NT & NetWare), SPS Account Review, Proactive Management Review, named S/w rep, Three Years (6-3 Part Number for Canada)	155341-122
--	------------

NOTE: For more information, customer/resellers can contact <http://www.compaq.com/services>.

Memory

Compaq ProLiant DL580 900 MHz Models

STANDARD MEMORY

1024-MB PC100-MHz Advanced ECC SDRAM DIMM installed (4 x 256-MB SDRAM DIMM)

STANDARD MEMORY PLUS OPTIONAL MEMORY

Up to 13,312-MB memory is available with the optional installation of PC100-MHz Advanced ECC SDRAM DIMM memory kits.

STANDARD MEMORY REPLACED WITH OPTIONAL MEMORY

Up to 16,384-MB memory is available with the removal of the standard 1024-MB of memory and the optional installation of PC100-MHz Advanced ECC SDRAM DIMM memory kits.

NOTE: Memory must be added in banks of four DIMMS. This chart does not represent all possible memory configurations.

Memory		Slot															
		1	2	3	4	5	6	7	8	9	10	11	12	13	14	15	16
Standard	1024MB	256 MB	256 MB	256 MB	256 MB	Empty	Empty	Empty	Empty	Empty	Empty	Empty	Empty	Empty	Empty	Empty	Empty
Optional	13,312 MB	256 MB	256 MB	256 MB	256 MB	1024 MB	1024 MB	1024 MB	1024 MB	1024 MB	1024 MB	1024 MB	1024 MB	1024 MB	1024 MB	1024 MB	1024 MB
Maximum	16,384 MB	1024 MB	1024 MB	1024 MB	1024 MB	1024 MB	1024 MB	1024 MB	1024 MB	1024 MB	1024 MB	1024 MB	1024 MB	1024 MB	1024 MB	1024 MB	1024 MB

Following are memory options available from Compaq:

- 4096-MB PC100 Registered ECC SDRAM Memory Kit (4 x 1024 MB) 189083-B21
- 2048-MB PC100 Registered ECC SDRAM Memory Kit (4 x 512 MB) 189082-B21
- 1024-MB PC100 Registered ECC SDRAM Memory Kit (4 x 256 MB) 189081-B21
- 512-MB PC100 Registered ECC SDRAM Memory Kit (4 x 128 MB) 189080-B21

Memory

Compaq ProLiant DL580 700 MHz Models

STANDARD MEMORY

512-MB PC100-MHz Advanced ECC SDRAM DIMM installed (4 x 128-MB SDRAM DIMM)

STANDARD MEMORY PLUS OPTIONAL MEMORY

Up to 12,800-MB memory is available with the optional installation of PC100-MHz Advanced ECC SDRAM DIMM memory kits.

STANDARD MEMORY REPLACED WITH OPTIONAL MEMORY

Up to 16,384-MB memory is available with the removal of the standard 512-MB of memory and the optional installation of PC100-MHz Advanced ECC SDRAM DIMM memory kits.

NOTE: Memory must be added in banks of four DIMMS. This chart does not represent all possible memory configurations.

Memory		Slot															
		1	2	3	4	5	6	7	8	9	10	11	12	13	14	15	16
Standard	512MB	128 MB	128 MB	128 MB	128 MB	Empty	Empty	Empty	Empty	Empty	Empty	Empty	Empty	Empty	Empty	Empty	Empty
Optional	12,800 MB	128 MB	128 MB	128 MB	128 MB	1024 MB	1024 MB	1024 MB	1024 MB	1024 MB	1024 MB	1024 MB	1024 MB	1024 MB	1024 MB	1024 MB	1024 MB
Maximum	16,384 MB	1024 MB	1024 MB	1024 MB	1024 MB	1024 MB	1024 MB	1024 MB	1024 MB	1024 MB	1024 MB	1024 MB	1024 MB	1024 MB	1024 MB	1024 MB	1024 MB

Following are memory options available from Compaq:

- 4096-MB PC100 Registered ECC SDRAM Memory Kit (4 x 1024 MB) 189083-B21
- 2048-MB PC100 Registered ECC SDRAM Memory Kit (4 x 512 MB) 189082-B21
- 1024-MB PC100 Registered ECC SDRAM Memory Kit (4 x 256 MB) 189081-B21
- 512-MB PC100 Registered ECC SDRAM Memory Kit (4 x 128 MB) 189080-B21

Storage

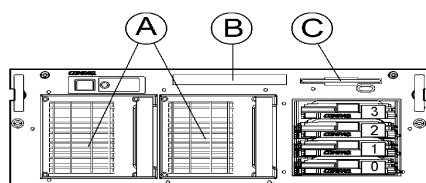

- A Hot Plug Power Supplies
- B 24x IDE CD-ROM
- C 1.44-MB Diskette Drive
- 0-3 Wide Ultra2/Ultra3 Drive Cage (4 x 1")

DRIVE SUPPORT

	Quantity Supported	Position Supported	Controller
Removable Media			
1.44-MB Diskette Drive	Up to 1	C	Integrated
IDE CD-ROM Drive	Up to 1	B	Integrated IDE

Hard Drives

Ultra320 Hot Pluggable Drives

1-inch	Up to 4	0-3	Integrated Smart Array Controller
146.8-GB 10,000 rpm			Smart Array 532 Controller
72.8-GB 10,000 rpm			Smart Array 5302/128 Controller
36.4-GB 10,000 rpm			Smart Array 5304/256 Controller
72.8-GB 15,000 rpm			Smart Array 5312 Controller
36.4-GB 15,000 rpm			64-bit/66-MHz Single Channel Wide Ultra3 SCSI Adapter
18.2-GB 15,000 rpm			64-bit/66-MHz Dual Channel Wide Ultra3 SCSI Adapter
			64-Bit/133-MHz Dual Channel Ultra320 SCSI Adapter

NOTE: All U320 Universal Hard Drives are backward compatible to U2 or U3 speeds. U320 drives require an optional U320 Smart Array Controller or U320 SCSI HBA to support U320 transfer rates.

StorageWorks Enclosure 4300 (supports Ultra2/Ultra3 drives only)	Up to 20 (using Smart Array 5300 Controller)	External	Integrated Smart Array Controller Smart Array 532 Controller Smart Array 5302/128 Controller Smart Array 5304/256 Controller Smart Array 5312 Controller 64-bit/66-MHz Single Channel Wide Ultra3 SCSI Adapter 64-bit/66-MHz Dual Channel Wide Ultra3 SCSI Adapter 64-Bit/133-MHz Dual Channel Ultra320 SCSI Adapter
---	--	----------	---

MSA 1000	Please see the MSA 1000 QuickSpecs below to determine configuration requirements	External	Please see the MSA 1000 QuickSpecs (URL below) for the latest list of supported HBA's
----------	--	----------	---

MSA 1000: http://www5.compaq.com/products/quickspecs/11033_div/11033_div.HTML

Maximum Internal Hot Plug Storage Capacity – (External StorageWorks Enclosure Attached)

Internal	587.2 GB (4 x 146.8-GB Ultra320 1" Drives)
External	41.104 TB (20 x (14 x 146.8-GB 1" Ultra320 1" Drives))
Total	41.691 TB

Storage

DRIVE SUPPORT *(continued)*

	Quantity Supported	Position Supported	Controller
Tape Drives			
NOTE: For an up-to-date listing of the latest O/S Support details for each of the Tape Drives listed below, please see the following: http://www5.compaq.com/products/quickspecs/North_America/10233.html (North America) http://www5.compaq.com/products/quickspecs/Division/10233.html (Division/World Wide)			
NOTE: For an up-to-date listing of the latest O/S Support details for each of the Tape Storage Systems listed below, please see the following: http://www5.compaq.com/products/quickspecs/North_America/10809.html (North America) http://www5.compaq.com/products/quickspecs/Division/10809.html (Division/World Wide)			
Internal AIT 100-GB, Hot Plug Internal AIT 50-GB, Hot Plug Internal AIT 35-GB, LVD, Hot Plug Internal 20/40-GB DAT, Hot Plug	Up to 1	0 & 1 or 2 & 3	Integrated Smart Array Controller NOTE: The Integrated Smart Array Controller does not support the AIT 100-GB Hot Plug Tape Drive. Smart Array 532 Controller NOTE: The Smart Array 532 Controller does not support the AIT 100-GB Hot Plug Tape Drive. Smart Array 5302/128 Controller Smart Array 5304/256 Controller Smart Array 5312 Controller 64-Bit/66-MHz Dual Channel Wide Ultra3 SCSI Adapter 64-Bit/66-MHz Single Channel Wide Ultra3 SCSI Adapter 64-Bit/133-MHz Dual Channel Ultra320 SCSI Adapter
External AIT 100-GB Tape Drive External AIT 50-GB Tape Drive External AIT 35-GB, LVD Tape Drive	Up to 2	External	Integrated Smart Array Controller 64-Bit/66-MHz Dual Channel Wide Ultra3 SCSI Adapter 64-Bit/66-MHz Single Channel Wide Ultra3 SCSI Adapter 64-Bit/133-MHz Dual Channel Ultra320 SCSI Adapter
HP StorageWorks AIT 35 GB Autoloader	Up to 1 (for a single HBA) Up to 2 (for a dual HBA)	External	64-bit/66-MHz Dual Channel Wide Ultra3 SCSI Adapter 64-bit/66-MHz Single Channel Wide Ultra3 SCSI Adapter 64-Bit/133-MHz Dual Channel Ultra320 SCSI Adapter
SDLT 110/220-GB, External	Up to 2	External	64-bit/66-MHz Dual Channel Wide Ultra3 SCSI Adapter 64-bit/66-MHz Single Channel Wide Ultra3 SCSI Adapter 64-Bit/133-MHz Dual Channel Ultra320 SCSI Adapter
External 40/80-GB DLT Enhanced	Up to 3	External	Integrated Smart Array Controller 64-Bit/66-MHz Dual Channel Wide Ultra3 SCSI Adapter 64-Bit/66-MHz Single Channel Wide Ultra3 SCSI Adapter 64-Bit/133-MHz Dual Channel Ultra320 SCSI Adapter
SSL2020 AIT Library	2 drives per SCSI channel	External	64-Bit/66-MHz Dual Channel Wide Ultra3 SCSI Adapter 64-Bit/133-MHz Dual Channel Ultra320 SCSI Adapter
MSL5026DLX (40/80GB DLT-based) MSL5026SL (SDLT-based) Library MSL5052SL (SDLT-based) Library MSL5026S2 (SDLT-based) Library MSL5052S2 (SDLT-based) Library MSL5030L1 (LTO-based) Library MSL5060L1 (LTO-based) Library	2 drives per SCSI channel	External	64-Bit/66-MHz Dual Channel Wide Ultra3 SCSI Adapter
20/40-GB DAT 8 Cassette Autoloader External	Up to 1	External	64-bit/66-MHz Dual Channel Wide Ultra3 SCSI Adapter 64-bit/66-MHz Single Channel Wide Ultra3 SCSI Adapter 64-Bit/133-MHz Dual Channel Ultra320 SCSI Adapter

Storage

DRIVE SUPPORT *(continued)*

	Quantity Supported	Position Supported	Controller
Tape Drives <i>(continued)</i>			
DLT1 1280 SuperLoader	Up to 2	External	64-bit/66-MHz Dual Channel Wide Ultra3 SCSI Adapter 64-bit/66-MHz Single Channel Wide Ultra3 SCSI Adapter 64-Bit/133-MHz Dual Channel Ultra320 SCSI Adapter
ESL9198SL ESL9322S2 ESL9322L1 ESL9326SL ESL9595SL ESL9595S2 ESL9595L1	Please see the ESL Library QuickSpecs below to determine configuration requirements	External	64-bit/66-MHz Dual Channel Wide Ultra3 SCSI Adapter
ESL9198SL:	http://www5.compaq.com/products/quickspecs/10867_div/10867_div.HTML		
ESL9326SL:	http://www5.compaq.com/products/quickspecs/10868_div/10868_div.HTML		
ESL9595SL:	http://www5.compaq.com/products/quickspecs/11332_div/11332_div.HTML		
ESL9322S2:	http://www5.compaq.com/products/quickspecs/11437_div/11437_div.HTML		
ESL9322L1:	http://www5.compaq.com/products/quickspecs/11445_div/11445_div.HTML		
ESL9595S2:	http://www5.compaq.com/products/quickspecs/11436_div/11436_div.HTML		
ESL9595L1:	http://www5.compaq.com/products/quickspecs/11435_div/11435_div.HTML		

Power Specifications

POWER SPECIFICATIONS

Part Number	401401-001
Spare Kit	101920-001
Operational Input Voltage Range (V rms)	90 to 264
Frequency Range (Nominal) (Hz)	47 to 63 (50/60)

Nominal Input Voltage (Vrms)	100	115	208	220	230	240
Max Rated Output Wattage Rating	450	450	450	450	450	450
Nominal Input Current (A rms)	7.1	6.0	3.3	3.1	2.9	2.7
Max Rated Input Wattage Rating (Watts)	692	682	672	662	652	643
Max. Rated VA (Volt-Amp)	706	696	685	675	665	656
Efficiency (%)	65	66	67	68	69	70
Power Factor	0.98	0.98	0.98	0.98	0.98	0.98
Leakage Current (mA)	0.63	0.72	1.30	1.38	1.00	1.50
Maximum Inrush Current (A peak)	125	144	260	275	288	300
Maximum Inrush Current duration (mS)	2	2	2	2	2	2

SYSTEM SPECIFICATIONS

DL580 Fully Configured

Up to 4 Processors, 16 Memory Slots, 4 Hard Drives, 6 PCI Slots, and 2 Hot Plug Power Supplies

Nominal Input Voltage (Vrms)	100	115	208	220	230	240
Fully Loaded System Input Wattage (W)	519	511	503	496	488	481
Fully Loaded System Thermal (BTU-Hr)	1768	1741	1715	1690	1666	1642
System Leakage with all power supplies loaded (mA)	1.25	1.44	2.60	2.75	2.00	3.01
System Inrush Current with all power supplies loaded (A)	250	288	520	550	576	600
Power cord requirements	Nema 5-15P to IEC320-C13			Option no./Spare no: See Power Cord chart		
	IEC320-C13 to IEC320-C14			Option no./Spare no: 142259-001/142258-B21		

NOTES:

ActiveAnswers™ Power Calculation

Power calculator is LIVE on ActiveAnswers website. This is an external link.

Follow this link:

<http://activeanswers.compaq.com/aaconfiguratorcode/configurationUi.asp?HTMLFilename=Mainselections&UiLocalization=UnitedStates&DisplayCountry=United%20States>

To drill down to calculators:

- Click on: "ProLiant Servers"
- Click on the Server of interest. Example: DL580
- Click on: "Power Calculator" link (You may need to scroll down to see it.)

Power Specifications

Power Cords (13 Cord Sets)	Power Cord Part Number
Country	
APD	139867-006
APD	100613-003
APD	100614-003
Australia	100611-007
Europe	100614-003
France	100614-003
Germany	100614-003
Japan	139867-006
PRC	139867-006
PRC	100613-003
PRC	100661-007
UK	100613-003
US	163719-002

Technical Specifications

System Unit Rack	Dimensions (HxWxD)	6.94 x 19 x 28.3 in/17.6 x 48.3 x 71.9 cm		
	Chassis Footprint (HxWxD)	6.94 x 19 x 25 in/17.6 x 48.3 x 63.5 cm		
	Weight	66 lb/29.9 kg		
	No hard drives installed, one power supply			
	Input Requirements	Rated Input Voltage	90 to 120 VAC/200 to 240 VAC	
		Rated Input Frequency	50 to 60 Hz	
		Input Power	600W @ 110 VAC/600W @ 220 VAC	
		Rated Input Current	7A (90 VAC), 5A (120 VAC), 3A (210 VAC)	
	BTU Rating	2291 BTU		
	SCSI Connector	One 68-pin connector supporting Wide Ultra2 SCSI		
	Power Supply Output Power (per power supply)	Rated Steady-State Power	450W/450W (lowline/highline)	
		Maximum Peak Power	480W/480W (lowline/highline)	
	Temperature Range	Operating	50° to 95° F/10° to 35° C	
		Non-operating	-20° to 140° F/-29° to 60° C	
		Shipping	-22° to 122° F/-30° to 50° C	
	Relative Humidity (non-condensing)	Operating	20% to 80%	
		Non-operating	5% to 90%	
Maximum Wet Bulb Temperature	101.7°F/38.7°C			
Acoustic Noise	Idle (Fixed Disk Drives Spinning)			
	L_{wAd} (BELS)	7.24		
	L_{pAm} (dBA)	60.7		
	Operating (Random Seeks to Fixed Disks)			
	L_{wAd} (BELS)	7.25		
	L_{pAm} (dBA)	60.8		
1.44-MB Diskette Drive	Diskette Size	3.5 in		
	LED Indicators (front panel)	Green		
	Read/Write Capacity per Diskette (high/low density)	1.44 MB/720 KB		
	Drive Supported	One		
	Drive Height	One-third		
	Drive Rotation	300 rpm		
	Transfer Rate (high/low)	500/250 Kb/s		
	Bytes/Sector	512		
	Sectors/Track (high/low)	18/9		
	Tracks/Side (high/low)	80/80		
	Access Times	Track-to-Track (high/low)	3/6 ms	
		Average (high/low)	169/94 ms	
		Settling Time	15 ms	
		Latency Average	100 ms	
	Cylinders (high/low)	80/80		
Read/Write Heads	Two			

Technical Specifications

24X Max (or higher) IDE CD-ROM Drive Slim Line	Disk	Applicable Disk	CD-ROM (Mode 1 and 2) CD-DA, CD-XA (Mode 2, Form 1 and 2) Photo CD (Single and Multi-session) Mixed Mode (Audio and Data combined)	
		Capacity	540 MB (Mode 1, 12 cm) 650 MB (Mode 2, 12 cm)	
		Diameter	4.7 in, 3.15 in/12 cm, 8 cm	
		Rotational Speed	4200 rpm maximum	
		Center Hole	0.6 in/15 mm diameter	
		Thickness	1.2 mm	
		Track Pitch	1.6 μ m	
		Block Size	Mode 1	2,048
			Mode 2	2,340, 2,336, 1,024 bytes
			CD-DA	2,352 bytes
		CD-XA	2,328 bytes	
	Interface	IDE (ATAPI)		
	Access Times (typical)	Random	100 ms	
		Full-Stroke	2000 ms	
	Audio Output Level	Line-Out	0.7 VRMS at 47 kOhms	
		Headphone	0.6 VRMS at 32 kOhms (maximum volume)	
	Data Transfer Rate	Sustained	150 KB/s (single)	
		Burst	2100 to 3600 KB/s	
	Cache Buffer	128 KB		
	Start-up Time (typical)	< 7 seconds		
	Stop Time	< 4 seconds		
	Laser Parameters	Type	Semiconductor Laser GaAlAs	
		Wave Length	780 \pm 25 nm	
		Divergence Angle	53.5 $^{\circ}$ \pm 1.5 $^{\circ}$	
		Output Power	0.14 mW	
	Operating Conditions	Temperature	41 $^{\circ}$ to 113 $^{\circ}$ F/5 $^{\circ}$ to 45 $^{\circ}$ C	
		Humidity	10% to 80%	
	Dimensions	(HxWxD, maximum)	1.69 x 5.75 x 8.19 in/4.29 x 15 x 20.8 cm	
		Weight	2.66 lb/1.2 kg	

Technical Specifications

Integrated Smart Array Controller	Data Compatible with all Smart Array Controllers	Yes
	Instant Upgrades to other Smart Array Controllers	Yes
	Consistent Software Manageability Tools	Yes
	PCI Bus	32-bit, 33 MHz (integrated on peripheral board)
	PCI Peak Data Transfer Rate	133 MB/s
	SCSI Protocols Supported	Ultra2, Wide-Ultra
	SCSI Peak Data Transfer Rate	80 MB/s
	NOTE: For ProLiant servers having TWO internal drive bays on separate SCSI ports: SCSI Peak Data Transfer Rate is 160 MB/s total; 80 MB/s per channel and Channels is 2.	
	Channels	2
	NOTE: For ProLiant servers having two internal drive bays on separate SCSI ports: SCSI Peak Data Transfer Rate is 160 MB/s total; 80 MB/s per channel and Channels is 2. The second channel on the DL580 is for external tape support only.	
	SCSI Ports (external/internal)	1/1
	NOTE: For ProLiant servers having two internal drive bays on separate SCSI ports: SCSI Peak Data Transfer Rate is 160 MB/s total; 80 MB/s per channel and Channels is 2. The DL580 has a SCSI port at the back of the server for external tape support only.	
	Drives Supported (maximum)	Maximum = total number of drives
	NOTE: Maximum is the total number of internal drives on each specific ProLiant server.	
	Cache	8-MB read only
	RAID Support	0, 1, 1+0, 5
	Logical Drives (maximum)	32
	Online Configuration	Yes
	Online Capacity Expansion	Yes
	Logical Drive Capacity Extension	Yes
	Online Stripe Size Migration	Yes
	Online RAID Level Migration	Yes
	Online Spare Support	Yes
	Automatic Data Recovery	Yes
	Drive Roaming	Yes
	Redundant Controllers	No

Technical Specifications

Compaq NC3134 Fast Ethernet NIC 64 PCI Dual Base 10/100	Network Interface	10Base-T/100Base-TX	
	Compatibility	PCI v2.2, IEEE 802.3/802.3u compliant	
	Data Transfer Method	64-bit/66-MHz bus-master PCI	
	Network Transfer Rate	10Base-T (Half-Duplex), 10Base-2	10 Mb/s
		10Base-T (Full-Duplex)	20 Mb/s
		100Base-TX (Half-Duplex)	100 Mb/s
		100Base-TX (Full-Duplex)	200 Mb/s
	Connector	Dual RJ-45	
	I/O Address and Interrupt	Automatic Configuration	
Cable Support	10Base-T/100Base-TX	Categories 3, 4 or 5 UTP (2 or 4 pair); up to 328 ft/100 m Category 5 UTP (2 pair); up to 328 ft/100 m	

© 2003 Compaq Information Technologies Group, LP.

Compaq, the Compaq logo, ActiveAnswers, ActiveUpdate, CarePaq, Insight Manager, ProLiant, ROMPaq, SmartStart, StorageWorks and Survey Utility are trademarks of Compaq Information Technologies Group, L.P. in the U.S. and/or other countries. Microsoft and Windows NT are registered trademarks or trademarks of Microsoft Corporation in the U.S. and/or other countries. Intel, Pentium and Xeon are registered trademarks or trademarks of Intel Corporation in the U.S. and/or other countries. Novell and NetWare are registered trademarks or trademarks of Novell, Inc in the U.S. and/or other countries. SuSE and its logo are registered trademarks or trademarks of SuSE AG in the U.S and/or other countries. Linux is a registered trademark or trademark of Linus Torvalds in the U.S. and/or other countries. Sun and Solaris are registered trademarks or trademarks of Sun Microsystems, Inc., in the U.S. and/or other countries. Caldera, SCO and OpenServer are registered trademarks or trademarks of Caldera International, Inc., in the U.S. and/or other countries. Red Hat is a registered trademark or trademark of Red Hat Inc., in the U.S. and/or other countries. UnixWare is a registered trademark or trademark of The Open Group in the U.S. and/or other countries. All other product names mentioned herein may be trademarks of their respective companies.

Compaq shall not be liable for technical or editorial errors or omissions contained herein. The information is provided "as is" without warranty of any kind and is subject to change without notice. The warranties for Compaq products are set forth in the express limited warranty statements accompanying such products. Nothing herein should be construed as constituting an additional warranty.